

SAIL-M12W-K-3.OP**Weidmüller Interface GmbH & Co. KG**

Klingenbergstraße 26

D-32758 Detmold

Germany

Fon: +49 5231 14-0

Fax: +49 5231 14-292083

www.weidmueller.com



Your peripheral devices should be supplied with greater power. With our new M12 plug-in connector, more than 250 V and 2 A is possible without problems. The compact S- and T-coded M12 plug-in connectors are designed for the transmission of up to 630 V AC or 60 V DC and 12 A.

General ordering data

| | |
|------------|--|
| Type | SAIL-M12W-K-3.OP |
| Order No. | 2455230300 |
| Version | Power cable, One end without connector, M12, Number of poles : 5 (4 + PE), 3 m, pin, 90°, Shielded: No, LED: No, Sheath material: PUR, Halogen: No |
| GTIN (EAN) | 4050118470178 |
| Qty. | 1 pc(s). |

Creation date May 2, 2020 2:10:36 PM CEST

Catalogue status 17.04.2020 / We reserve the right to make technical changes.

SAIL-M12W-K-3.0P**Weidmüller Interface GmbH & Co. KG**

Klingenbergstraße 26

D-32758 Detmold

Germany

Fon: +49 5231 14-0

Fax: +49 5231 14-292083

www.weidmueller.com

Technical data**Dimensions and weights**

Net weight 200 g

Environmental Product Compliance

REACH SVHC Lead 7439-92-1

Technical specifications for cable

| | | | |
|--|--|-------------------------------|----------------------|
| Number of poles | 5 (4 + PE) | Core cross-section | 1.5 mm ² |
| Outside diameter | 8 mm ± 0.2 mm | Cable length | 3 m |
| Shielded | No | Insulation | PP |
| Colour coding | Green/yellow, black (1), black (2), black (3), black (4) | Sheath material | PUR |
| Sheathing colour | black | Halogen | No |
| Temperature range, moving | -30...80 °C | Temperature range, stationary | -40...80 °C |
| Outer cladding in accordance with UL AWM style | 20939 (80 °C / 600 V) | Suitable for cable carriers | Yes |
| Bending radius, min., stationary | 4 x cable diameter | Bending radius, min., moving | 7.5 x cable diameter |
| Acceleration | 5 m/s ² | Speed | 5 m/s |
| Bending cycles | 10 Mio | Resistant to welding beads | No |
| Configurable cable length | No | | |

General technical data

| | | | |
|------------------------------|-----------------------------|---------------------|-------------------|
| Version | pin, 90° | Connection thread | M12 |
| Housing main material | PUR | Coding | K |
| Protection degree | IP65, IP67, when screwed in | Contact surface | Gold-plated |
| LED | No | Rated voltage | 600 V |
| Rated current | 16 A | Insulation strength | 10 ⁸ Ω |
| Temperature range of housing | -25...+80 °C | Plugging cycles | ≤ 100 |
| Pollution severity | 3 | jumpered | No |

Standards

Connector standard IEC 61076-2-111 Certificate no. (cULus) E257571

Classifications

| | | | |
|-------------|-------------|------------|-------------|
| ETIM 6.0 | EC001855 | ETIM 7.0 | EC001855 |
| eClass 9.0 | 27-06-03-11 | eClass 9.1 | 27-06-03-11 |
| eClass 10.0 | 27-06-03-11 | | |

Approvals

Approvals



ROHS Conform

Creation date May 2, 2020 2:10:36 PM CEST

Catalogue status 17.04.2020 / We reserve the right to make technical changes.

2

Data sheet

SAIL-M12W-K-3.0P

Weidmüller Interface GmbH & Co. KG
Klingenbergstraße 26
D-32758 Detmold
Germany
Fon: +49 5231 14-0
Fax: +49 5231 14-292083
www.weidmueller.com

Technical data

Downloads

Brochure/Catalogue [FL FIELDWIRING EN](#)

SAIL-M12W-K-3.0P

Weidmüller Interface GmbH & Co. KG
 Klingenbergstraße 26
 D-32758 Detmold
 Germany
 Fon: +49 5231 14-0
 Fax: +49 5231 14-292083
 www.weidmueller.com

Drawings

Dimensioned drawing

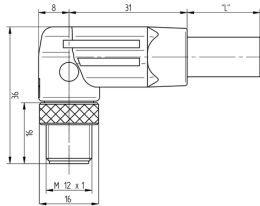

Pole scheme

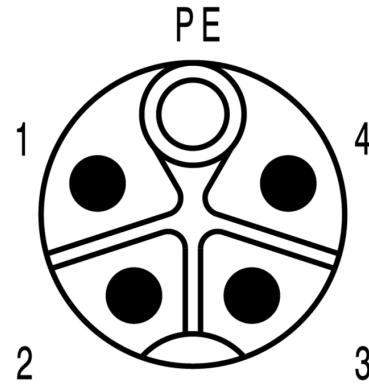

Wiring diagram

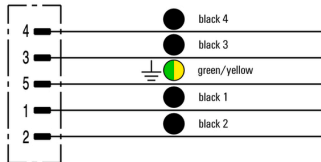

The ideal tool: Screwty[®] with torque function

