

## Industrial Ethernet IE-BS-V01M-LCD-SM-C

**Weidmüller Interface GmbH & Co. KG**  
Klingenbergstraße 26  
D-32758 Detmold  
Germany  
Fon: +49 5231 14-0  
Fax: +49 5231 14-292083  
www.weidmueller.com



Bayonet plug-in connector sets according to IEC  
61076-3-106 ver.1 (EtherNet/IP), RJ45 metal insert incl.  
LC insert

### General ordering data

Type	IE-BS-V01M-LCD-SM-C
Order No.	<a href="#">1963430000</a>
Version	Flange FO, IP67, Version 1, LC Duplex coupling, Singlemode
GTIN (EAN)	4032248645527
Qty.	10 pc(s).

Creation date May 3, 2020 6:11:50 AM CEST

Catalogue status 17.04.2020 / We reserve the right to make technical changes.

**Industrial Ethernet  
IE-BS-V01M-LCD-SM-C**

**Weidmüller Interface GmbH & Co. KG**  
Klingenbergstraße 26  
D-32758 Detmold  
Germany  
Fon: +49 5231 14-0  
Fax: +49 5231 14-292083  
www.weidmueller.com

**Technical data**
**Dimensions and weights**

Width	32 mm	Width (inches)	1.26 inch
Height	32 mm	Height (inches)	1.26 inch
Depth	33.3 mm	Depth (inches)	1.311 inch
Net weight	60 g		

**Temperatures**

Operating temperature, max.	70 °C	Operating temperature, min.	-40 °C
Operating temperature	-40 °C...70 °C		

**Environmental Product Compliance**

REACH SVHC	Lead 7439-92-1
------------	----------------

**General data**

Colour	Miscellaneous	Connection 1	LC Duplex
Connection 2		Description of article	Version 1, LC Duplex coupling
	LC Duplex		
Fibre type	Singlemode	Housing main material	Zinc diecast
Insertion loss	≤ 0.5 dB	Plugging cycles	500
Protection degree	IP67	Return loss (attenuation)	≥ 40 dB
Seal material	NBR		

**General standards**

Connector standard	IEC 61076-3-106 Var. 1, IEC 61754-20
--------------------	---

**Classifications**

ETIM 6.0	EC001122	ETIM 7.0	EC001122
eClass 9.0	19-17-01-22	eClass 9.1	19-17-01-22
eClass 10.0	19-17-01-22	UNSPSC	30-21-18-17

**Approvals**

ROHS	Conform
------	---------

**Downloads**

Approval/Certificate/Document of Conformity	<a href="#">GOST Approval</a>
Brochure/Catalogue	<a href="#">CAT 9 IETH 18/19 EN</a> <a href="#">FL FIELDWIRING EN</a> <a href="#">PI PROFINET CABLING EN</a>
Engineering Data	<a href="#">WSCAD</a>
Engineering Data	<a href="#">STEP</a>
Product Change Notification	<a href="#">Technical change to Bulkhead Variant 1 (Metal) - EN</a> <a href="#">Technical change to Bulkhead Variant 1 (Metal) - DE</a>
User Documentation	<a href="#">MAN IE GUIDE DE</a> <a href="#">MAN IE GUIDE EN</a> <a href="#">Designation key / Type key</a> <a href="#">Manual</a>

**Industrial Ethernet  
IE-BS-V01M-LCD-SM-C**

**Weidmüller Interface GmbH & Co. KG**  
Klingenbergstraße 26  
D-32758 Detmold  
Germany  
Fon: +49 5231 14-0  
Fax: +49 5231 14-292083  
www.weidmueller.com

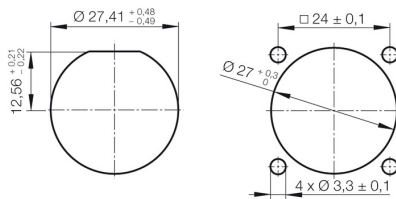
**Drawings****Installation cut-out**

Mounting cut-out: 1. With central screw connection / 2. For mounting with four M3 screws

**Industrial Ethernet  
IE-BS-V01M-LCD-SM-C**

**Weidmüller Interface GmbH & Co. KG**  
Klingenbergstraße 26  
D-32758 Detmold  
Germany  
Fon: +49 5231 14-0  
Fax: +49 5231 14-292083  
www.weidmueller.com

**Accessories****Dust caps**

For protecting your devices against dust and dirt.

**Dust caps****General ordering data**

Type	IE-BP-V01P	Version
Order No.	<a href="#">1965700000</a>	Flange-mounted housing, protective cap
GTIN (EAN)	4032248653928	
Qty.	10 pc(s).	