

FBC PA M12 FM 1M

Weidmüller Interface GmbH & Co. KG

Klingenbergstraße 26

D-32758 Detmold

Germany

Fon: +49 5231 14-0

Fax: +49 5231 14-292083

www.weidmueller.com

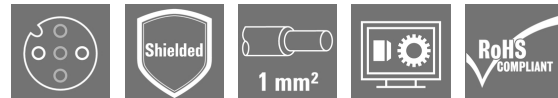

The most reliable way of achieving connections between two I/O slaves or between the control and one I/O subscriber is by way of pre-assembled cables. The line of cables covers PROFIBUS, CANopen, DeviceNet™, EtherCAT and Ethernet.

General ordering data

Type	FBC PA M12 FM 1M
Order No.	1785 110100
Version	Bus line, One end without connector, M12, Number of poles: 2, 1 m, Female socket, straight, Shielded: Yes, LED: No, Sheath material: PVC, Halogen: Yes
GTIN (EAN)	4032248194759
Qty.	1 pc(s).

Creation date May 3, 2020 2:15:07 PM CEST

Catalogue status 17.04.2020 / We reserve the right to make technical changes.

FBC PA M12 FM 1M

Weidmüller Interface GmbH & Co. KG

Klingenbergstraße 26

D-32758 Detmold

Germany

Fon: +49 5231 14-0

Fax: +49 5231 14-292083

www.weidmueller.com

Technical data

Dimensions and weights

Length	1,000 mm	Length (inches)	39.37 inch
Net weight	97 g		

Environmental Product Compliance

REACH SVHC	Lead 7439-92-1
------------	----------------

Technical specifications for cable

Number of poles	2	Core cross-section	1 mm ²
Outside diameter	8 mm ± 0.4 mm	Cable length	1 m
Shielded	Yes	Insulation	PE
Colour coding	red, green	Sheath material	PVC
Sheathing colour	black	Halogen	Yes
Temperature range, moving	-5...60 °C	Temperature range, stationary	-30...80 °C
Suitable for cable carriers	No	Bending radius, min., stationary	8 x Kabeldurchmesser
Bending radius, min., moving	8 x Kabeldurchmesser	Resistant to welding beads	No
Hybrid cable	No	Irradiation crosslinked	No
Configurable cable length	No		

General technical data

Version	Female socket, straight	Connection thread	M12
Housing main material	PUR	Threaded ring material	Brass, nickel-plated
Coding	A	Protection degree	IP67
Contact surface	Gold-plated	LED	No
Rated voltage	100 V	Insulation strength	10 ⁸ Ω
Temperature range of housing	-25...+80 °C	Tightening torque	M12: 0.8 - 1.2 Nm
Plugging cycles	≥ 100	Pollution severity	3
jumpered	No		

Classifications

ETIM 6.0	EC002599	ETIM 7.0	EC002599
eClass 9.0	27-06-03-08	eClass 9.1	27-06-03-08
eClass 10.0	27-06-03-08	UNSPSC	26-12-16-03

Approvals

ROHS	Conform
------	---------

Downloads

Brochure/Catalogue	CAT 8 SAI 15/16 EN FL FIELDWIRING EN
Engineering Data	EPLAN, WSCAD

FBC PA M12 FM 1M

Weidmüller Interface GmbH & Co. KG
Klingenbergstraße 26
D-32758 Detmold
Germany
Fon: +49 5231 14-0
Fax: +49 5231 14-292083
www.weidmueller.com

Drawings

Dimensioned drawing

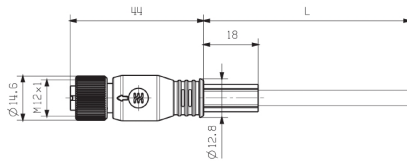

Straight socket

Wiring diagram

Pole scheme

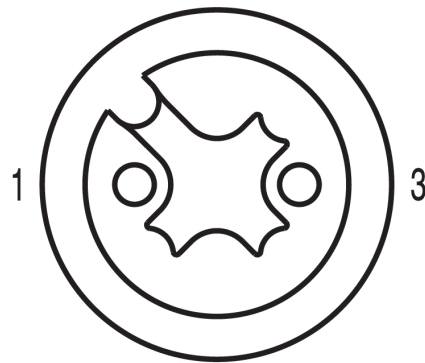

Socket

The ideal tool: Screwty[®] with torque function



Light, securely screwed-in round plug-in connectors. Screwty set DM / VPE: 1 / Order No.: 1920000000 Adapters: M12, M12 F, M8, M8 F