

**Crimping contact  
HDC-C-HE-BM0.75-1.00AU**

**Weidmüller Interface GmbH & Co. KG**  
 Klingenbergstraße 26  
 D-32758 Detmold  
 Germany  
 Fon: +49 5231 14-0  
 Fax: +49 5231 14-292083  
 www.weidmueller.com



Crimps provide a electrical and mechanical connection between wire and contact that is both secure and reliable. The optimal crimp connection is gas-tight and corrosion-resistant.

**General ordering data**

|            |  |
|------------|--|
| Type       | HDC-C-HE-BM0.75-1.00AU   |
| Order No.  | <a href="#">1651480000</a>   |
| Version    | Heavy-duty connectors, Crimp contact, HE, HEE, HQ, MixMate, Female, Conductor cross-section, max.: 1, turned, Copper alloy |
| GTIN (EAN) | 4008190400156  |
| Qty.       | 100 pc(s).   |

**Crimping contact  
HDC-C-HE-BM0.75-1.00AU**

**Weidmüller Interface GmbH & Co. KG**  
 Klingenbergstraße 26  
 D-32758 Detmold  
 Germany  
 Fon: +49 5231 14-0  
 Fax: +49 5231 14-292083  
 www.weidmueller.com

**Technical data**
**Dimensions and weights**

|            |        |          |        |
|------------|--------|----------|--------|
| Net weight | 1.57 g | Diameter | 4.5 mm |
|------------|--------|----------|--------|

**Environmental Product Compliance**

|            |                |
|------------|----------------|
| REACH SVHC | Lead 7439-92-1 |
|------------|----------------|

**General data**

|                                    |                      |                                  |                          |
|------------------------------------|----------------------|----------------------------------|--------------------------|
| Contact diameter, male Ø           | 2.5 mm               | Cross-section for connected wire | 0.75 - 1 mm <sup>2</sup> |
| Material                           | Copper alloy         | Plugging cycles                  | ≥ 500                    |
| Production methods                 | turned               | Series                           | HE                       |
| Stripping length, rated connection | 7.5 mm               | Surface finish                   | gold                     |
| Surface layer thickness, max.      | 1.25 µm              | Surface layer thickness, min.    | 0.75 µm                  |
| Type                               | Female               | Type of connection               | Crimp connection         |
| Version insert                     | HE, HEE, HQ, MixMate | Volume resistance                | ≤ 2mΩ                    |

**Classifications**

|             |             |            |             |
|-------------|-------------|------------|-------------|
| ETIM 6.0    | EC000796    | ETIM 7.0   | EC000796    |
| eClass 9.0  | 27-44-02-04 | eClass 9.1 | 27-44-02-04 |
| eClass 10.0 | 27-44-02-04 | UNSPSC     | 30-21-18-01 |

**Approvals**

Approvals



ROHS Conform

**Downloads**

|                    |   |
|--------------------|---|
| Brochure/Catalogue | <a href="#">CAT 3 HDC 17/18 EN</a><br><a href="#">FL FIELDWIRING EN</a> |
| Engineering Data   | <a href="#">EPLAN, WSCAD</a>  |
| Engineering Data   | <a href="#">STEP</a>  |

**Data sheet**

**Crimping contact  
HDC-C-HE-BM0.75-1.00AU**

**Weidmüller Interface GmbH & Co. KG**  
 Klingenbergstraße 26  
 D-32758 Detmold  
 Germany  
 Fon: +49 5231 14-0  
 Fax: +49 5231 14-292083  
 www.weidmueller.com

**Drawings**

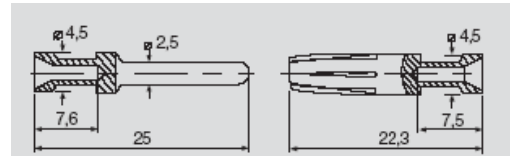

| Leiterquerschnitt           | Abisolierlänge |        |
|-----------------------------|----------------|--------|
| 0,50 mm <sup>2</sup>        | AWG 20         | 7,5 mm |
| 0,75 - 1,00 mm <sup>2</sup> | AWG 18         | 7,5 mm |
| 1,50 mm <sup>2</sup>        | AWG 16         | 7,5 mm |
| 2,50 mm <sup>2</sup>        | AWG 14         | 7,5 mm |
| 4,00 mm <sup>2</sup>        | AWG 12         | 7,5 mm |

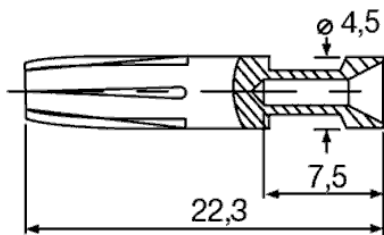

**Data sheet**

**Crimping contact  
HDC-C-HE-BM0.75-1.00AU**

**Weidmüller Interface GmbH & Co. KG**  
 Klingenbergstraße 26  
 D-32758 Detmold  
 Germany  
 Fon: +49 5231 14-0  
 Fax: +49 5231 14-292083  
 www.weidmueller.com

**Accessories**

**Non-contact tools**



Tools for dismantling Weidmüller crimp contacts

**General ordering data**

|            |                            |                             |
|------------|----------------------------|-----------------------------|
| Type       | REMOVAL TOOL HE            | Version                     |
| Order No.  | <a href="#">1866750000</a> | Tools, Contact Removal Tool |
| GTIN (EAN) | 4032248437078              |                             |
| Qty.       | 1 pc(s).                   |                             |

**CTIN / CTX**



**Crimping tools for turned contacts**

- Ratchet guarantees precise crimping
- Release option in the event of incorrect operation
- With stop for exact positioning of the contacts.

**General ordering data**

|            |                            |  |
|------------|----------------------------|--|
| Type       | CTX CM 1.6/2.5             | Version  |
| Order No.  | <a href="#">9018490000</a> | Pressing tool, Crimping tool for contacts, 0.14mm <sup>2</sup> , 4mm <sup>2</sup> , W crimp        |
| GTIN (EAN) | 4008190884598              |  |
| Qty.       | 1 pc(s).                   |  |
| Type       | CTIN CM 1.6/2.5            | Version  |
| Order No.  | <a href="#">9205430000</a> | Pressing tool, Crimping tool for contacts, 0.14mm <sup>2</sup> , 6mm <sup>2</sup> , 4-indent crimp |
| GTIN (EAN) | 4032248733446              |  |
| Qty.       | 1 pc(s).                   |  |