

**Industrial Ethernet
IE-CL240W-PP-BASE**

Weidmüller Interface GmbH & Co. KG
Klingenbergstraße 26
D-32758 Detmold
Germany
Fon: +49 5231 14-0
Fax: +49 5231 14-292083
www.weidmueller.com



Contactless and maintenance-free energy transmission up to 240 W – FreeCon Contactless offers top performance with the smallest dimensions and maximum efficiency.

General ordering data

Type	IE-CL240W-PP-BASE
Order No.	1547440000
Version	Contactless power transmission, Primary side
GTIN (EAN)	4050118352887
Qty.	1 pc(s).

Creation date May 4, 2020 1:01:43 AM CEST

Catalogue status 17.04.2020 / We reserve the right to make technical changes.

**Industrial Ethernet
IE-CL240W-PP-BASE**

Weidmüller Interface GmbH & Co. KG
 Klingenbergstraße 26
 D-32758 Detmold
 Germany
 Fon: +49 5231 14-0
 Fax: +49 5231 14-292083
 www.weidmueller.com

Technical data**Dimensions and weights**

Length	100 mm	Length (inches)	3.937 inch
Width	100 mm	Width (inches)	3.937 inch
Height	50 mm	Height (inches)	1.969 inch
Weight	1,020 g	Net weight	1.236 g

Temperatures

Operating temperature, max.	45 °C	Operating temperature, min.	-20 °C
Operating temperature	-20 °C...45 °C	Note: room temperature (service)	Consider derating

Environmental Product Compliance

REACH SVHC	Lead 7439-92-1
------------	----------------

General data

Air gap	0...5 mm	Centre offset	max. 5mm
Housing main material	Diecast zinc, painted, Cover PBT	Loads	Inductive and resistive loads
Power interface	PROFINET PushPull Power	Protection degree	IP65
Technologie, version	Inductive resonance coupling	Turn-on time	1 s
Weight	1,020 g		

Electrical properties

Degree of efficiency	max. 91 %	LED indicator	Status indication via multi-coloured LED
Primary voltage	24 V DC (21.6...26.4 V DC)		

Classifications

ETIM 6.0	EC002542	ETIM 7.0	EC002542
eClass 9.0	27-04-07-04	eClass 9.1	27-04-91-90
eClass 10.0	27-04-07-04		

Downloads

Approval/Certificate/Document of Conformity	EMV / EMC Test CE_FreeCon_Contactless.pdf
Brochure/Catalogue	CAT 9 IETH 18/19 EN MB FREECONCONTACT EN FL FIELDWIRING EN PI PROFINET CABLING EN
Engineering Data	STEP
User Documentation	MAN IE GUIDE DE MAN IE GUIDE EN Short Manual
White paper	Whitepaper FreeCon Contactless Whitepaper FreeCon Contactless

Data sheet

**Industrial Ethernet
IE-CL240W-PP-BASE**

Weidmüller Interface GmbH & Co. KG
 Klingenbergstraße 26
 D-32758 Detmold
 Germany
 Fon: +49 5231 14-0
 Fax: +49 5231 14-292083
 www.weidmueller.com

Drawings

Dimensioned drawing

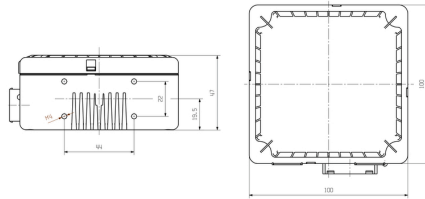

Derating curve

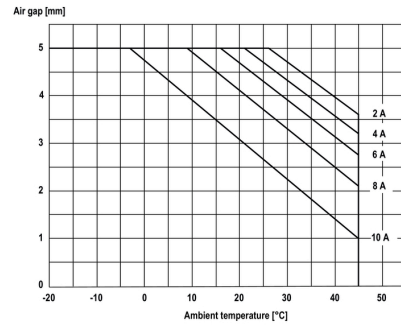

**Industrial Ethernet
IE-CL240W-PP-BASE**

Weidmüller Interface GmbH & Co. KG
 Klingenbergstraße 26
 D-32758 Detmold
 Germany
 Fon: +49 5231 14-0
 Fax: +49 5231 14-292083
 www.weidmueller.com

Accessories

UPS control unit



The UPS control unit together with the associated battery module and the power supply unit form a complete DC UPS system. In normal operation, the input voltage from the UPS control unit is connected directly to the load. In the event of a mains failure (drop of the DC input voltage) the system switches instantly to battery operation. Once the mains supply has been restored, the system switches back to normal operation and the battery is fully recharged by the integrated charger. Three relay outputs, as well as three additional active transistor outputs and a control input to lock battery operation, provide full remote control by means of SPS or DCS control. Numerous modes of operation and an easy-to-use status display provide rapid fault diagnosis and optimum customisation to the application.

General ordering data

Type	CP DC UPS 24V 20A/10A	Version
Order No.	1370050010	UPS control unit
GTIN (EAN)	4050118202335	
Qty.	1 pc(s).	

**Industrial Ethernet
IE-CL240W-PP-BASE**

Weidmüller Interface GmbH & Co. KG
 Klingenbergstraße 26
 D-32758 Detmold
 Germany
 Fon: +49 5231 14-0
 Fax: +49 5231 14-292083
 www.weidmueller.com

Accessories

Blank



ESG is the tried-and-tested marker in MultiCard format for use on many well-known electrical devices. The result is high-quality device marking with a high-contrast appearance.

Various types are available for devices from the following manufacturers:

- Siemens
- Télémecanique
- ABB
- Beckhoff
- Lumberg
- Tags for all-purpose usage; self-adhesive or clip-on tags, depending on the type

Advantages at a glance:

- Tags for universal usage, self-adhesive or clip-on tags, depending on type
- For aligned equipment, e.g. circuit breakers, we supply ESG markers for clipping onto tag rails
- Individual laser-quality printing according to specifications

For custom printing: Please send us a file of our labeling software M-Print PRO or M-Print PRO Online (without installation) for your labeling specifications.

Please note that these markers are not intended for printing with the SpeedMarking laser.

General ordering data

Type	ESG 6/17 K MC NE WS	Version
Order No.	1880120000	ESG, Device markers x 17 mm, PA 66, Colour: white, Self-adhesive
GTIN (EAN)	4032248478804	
Qty.	200 pc(s).	

**Industrial Ethernet
IE-CL240W-PP-BASE**

Weidmüller Interface GmbH & Co. KG
Klingenbergstraße 26
D-32758 Detmold
Germany
Fon: +49 5231 14-0
Fax: +49 5231 14-292083
www.weidmueller.com

Accessories

Battery module



The Weidmüller battery modules consist of high-quality Panasonic batteries. These are sealed, maintenance-free lead-fleece batteries. The battery modules are fitted with a temperature sensor to provide optimum battery charging and battery life. This facilitates temperature-compensated charging of the batteries.

The neat design as well as the plug-in connections for the battery connection and the temperature sensor allow the batteries to be fitted safely and quickly.

General ordering data

Type	CP A BATTERY 24V DC17AH	Version	
Order No.	1251110000	Battery	
GTIN (EAN)	4050118043136		
Qty.	1 pc(s).		

Sets

PushPull Power plug-in connector according to PROFINET specification



General ordering data

Type	IE-PS-VAPM-24V	Version	
Order No.	1068910000	Power connector, Plug, PROFINET, Set of connectors	
GTIN (EAN)	4032248823079		
Qty.	10 pc(s).		