

ACT20C ACT20C-LBT-10

Weidmüller Interface GmbH & Co. KG
Klingenbergstraße 26
D-32758 Detmold
Germany
Fon: +49 5231 14-0
Fax: +49 5231 14-292083
www.weidmueller.com

Product image



Accessories for the analogue signal processing products:

- End plates: for components with terminal-block design
- Retaining clips: for mounting IP6X signal isolators and displays
- Calibration devices: for calibrating and setting analogue signal converters
- MICRO interface: for direct transmission to a controller thus minimizing the wiring overhead
- markers
- Programming adapter: for configuring PC-configurable modules
- Cross-connector
- Power supply modules / power supplies
- Optional connection terminals and cold-junction compensation terminals

General ordering data

Type	ACT20C-LBT-10
Order No.	1510340000
Version	Bus termination terminal
GTIN (EAN)	4050118319491
Qty.	1 pc(s).

Data sheet

ACT20C ACT20C-LBT-10

Weidmüller Interface GmbH & Co. KG
 Klingenbergstraße 26
 D-32758 Detmold
 Germany
 Fon: +49 5231 14-0
 Fax: +49 5231 14-292083
 www.weidmueller.com

Technical data

Dimensions and weights

Width	20.6 mm	Width (inches)	0.811 inch
Height	56 mm	Height (inches)	2.205 inch
Depth	63 mm	Depth (inches)	2.48 inch
Net weight	53.88 g		

Temperatures

Humidity	5...95 %, no condensation	Storage temperature, max.	85 °C
Storage temperature, min.	-40 °C	Ambient temperature	-25 °C...+60 °C
Storage temperature	-40 °C...85 °C		

Probability of failure

MTTF	120 Years
------	-----------

Environmental Product Compliance

REACH SVHC	Lead 7439-92-1
------------	----------------

communication

Configuration	none
---------------	------

General data

Configuration	none	Rail	TS 35
---------------	------	------	-------

Connection data

Tightening torque, min.	1.2 Nm	Tightening torque, max.	2.4 Nm
-------------------------	--------	-------------------------	--------

Classifications

ETIM 6.0	EC001583	ETIM 7.0	EC001583
eClass 9.0	27-14-31-54	eClass 9.1	27-14-31-54
eClass 10.0	27-14-31-54		

Product information

Product information	<p>The ACT20C-LBT-10 bus termination terminal is required as the electrical termination of the DIN rail bus on an ACT20C station. It also assumes the function of a mechanical end bracket.</p> <p>Properties</p> <ul style="list-style-type: none"> • Right-hand electrical termination of the internal communication bus on an ACT20C station • Assembly on a TS 35 DIN rail with integrated CH20M bus profile • Integrated mechanical end bracket function
---------------------	--

Approvals

Approvals



ROHS	Conform
------	---------

Creation date May 4, 2020 2:28:21 AM CEST

Catalogue status 17.04.2020 / We reserve the right to make technical changes.

Data sheet**ACT20C
ACT20C-LBT-10**

Weidmüller Interface GmbH & Co. KG
Klingenbergstraße 26
D-32758 Detmold
Germany
Fon: +49 5231 14-0
Fax: +49 5231 14-292083
www.weidmueller.com

Technical data**Downloads**

Approval/Certificate/Document of Conformity	DNV GL certification
Brochure/Catalogue	CAT 4.1 ELECTR 16/17 EN
Engineering Data	STEP
User Documentation	IS ACT20C-LBT-10 Manual

**ACT20C
ACT20C-LBT-10**

Weidmüller Interface GmbH & Co. KG
 Klingenbergstraße 26
 D-32758 Detmold
 Germany
 Fon: +49 5231 14-0
 Fax: +49 5231 14-292083
 www.weidmueller.com

Drawings

Dimensioned drawing

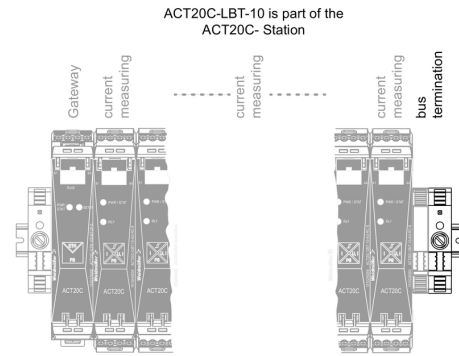
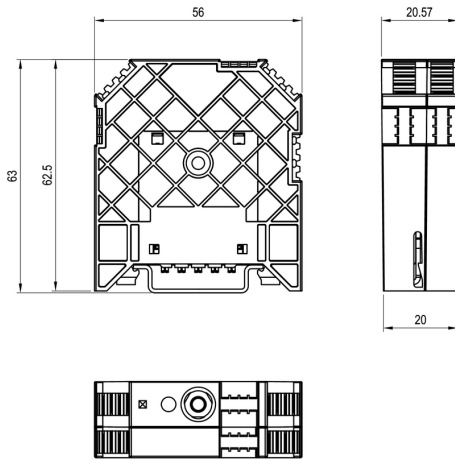

**ACT20C
ACT20C-LBT-10**

Weidmüller Interface GmbH & Co. KG
 Klingenbergstraße 26
 D-32758 Detmold
 Germany
 Fon: +49 5231 14-0
 Fax: +49 5231 14-292083
 www.weidmueller.com

Accessories

Accessories



Accessories for the analogue signal processing products:

- End plates: for components with terminal-block design
- Retaining clips: for mounting IP6X signal isolators and displays
- Calibration devices: for calibrating and setting analogue signal converters
- MICRO interface: for direct transmission to a controller thus minimizing the wiring overhead
- markers
- Programming adapter: for configuring PC-configurable modules
- Cross-connector
- Power supply modules / power supplies
- Optional connection terminals and cold-junction compensation terminals

General ordering data

Type	CH20M BUS-AP LI TS 35X7 ...	Version
Order No.	1193160000	OMNIMATE Housing - series CH20M, Length: 40.5 mm, Width: 5.1
GTIN (EAN)	4032248987771	mm
Qty.	50 pc(s).	
Type	SET CH20M BUS 250MM TS ...	Version
Order No.	1335140000	OMNIMATE Housing - series CH20M, Length: 250 mm, Width: 25.1
GTIN (EAN)	4050118138375	mm
Qty.	1 pc(s).	
Type	CH20M BUS-AP RE TS 35X7 ...	Version
Order No.	1193170000	OMNIMATE Housing - series CH20M, Length: 40.5 mm, Width: 5.1
GTIN (EAN)	4032248987924	mm
Qty.	50 pc(s).	