

**cable lug, terminal end
FSKI/1,5-2,5/638**

Weidmüller Interface GmbH & Co. KG
 Klingenbergstraße 26
 D-32758 Detmold
 Germany
 Fon: +49 5231 14-0
 Fax: +49 5231 14-292083
 www.weidmueller.com



Insulated tab connector made from PVC with copper sleeve

- Commercially available designs
- Not soldered
- With conical entry funnel

General ordering data

Type	FSKI/1,5-2,5/638
Order No.	1491830000
Version	cable lug, terminal end, Insulated cable connector, 1.5 mm ² - 2.5 mm ²
GTIN (EAN)	4050118301830
Qty.	100 pc(s).

Data sheet

cable lug, terminal end FSKI/1,5-2,5/638

Weidmüller Interface GmbH & Co. KG
 Klingenbergstraße 26
 D-32758 Detmold
 Germany
 Fon: +49 5231 14-0
 Fax: +49 5231 14-292083
 www.weidmueller.com

Technical data

Dimensions and weights

Weight	0.1 g	Net weight	1.018 g
--------	-------	------------	---------

Environmental Product Compliance

REACH SVHC	Lead 7439-92-1
------------	----------------

Connectors

Conductor cross-section, max.	2.5 mm ²	Conductor cross-section, min.	1.5 mm ²
Identification colour	blue	Length 1 (l1)	21.8 mm
Material/plastic	PVC	Plug-in density (d3)	0.8 mm
Plug-in width (d2)	6.3 mm		

Classifications

ETIM 6.0	EC000516	ETIM 7.0	EC000516
eClass 9.0	27-44-03-92	eClass 9.1	27-40-02-90
eClass 10.0	27-44-03-92		

Approvals

ROHS	Conform
------	---------

Downloads

Brochure/Catalogue	CAT 6 TOOLS 15/16 EN
Engineering Data	EPLAN

Data sheet

**cable lug, terminal end
FSKI/1,5-2,5/638**

Weidmüller Interface GmbH & Co. KG
Klingenbergstraße 26
D-32758 Detmold
Germany
Fon: +49 5231 14-0
Fax: +49 5231 14-292083
www.weidmueller.com

Drawings

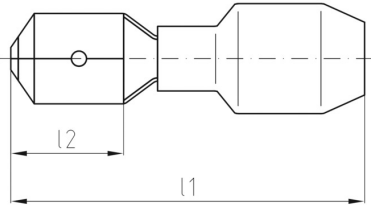

**cable lug, terminal end
FSKI/1,5-2,5/638**

Weidmüller Interface GmbH & Co. KG
 Klingenbergstraße 26
 D-32758 Detmold
 Germany
 Fon: +49 5231 14-0
 Fax: +49 5231 14-292083
 www.weidmueller.com

Accessories

CTI / HTI



Crimping tools for insulated connectors

cable lugs, terminal pins, parallel and serial connectors, plug-in connectors

- Ratchet guarantees precise crimping
- Release option in the event of incorrect operation
- With stop for exact positioning of the contacts.
- Tested to DIN EN 60352 part 2

General ordering data

Type	CTI 6	Version
Order No.	9006120000	Pressing tool, Crimping tool for contacts, 0.5mm ² , 6mm ² , Oval crimping, Double crimp
GTIN (EAN)	4008190044527	
Qty.	1 pc(s).	
Type	HTI 15	Version
Order No.	9014400000	Pressing tool, Tool for insulated cable connectors, 0.5mm ² , 2.5mm ² , Double crimp
GTIN (EAN)	4008190159412	
Qty.	1 pc(s).	
Type	CTI 6 G	Version
Order No.	9202850000	Pressing tool, Tool for insulated cable connectors, 0.5mm ² , 6mm ² , Oval crimping, Parallel crimp
GTIN (EAN)	4032248517855	
Qty.	1 pc(s).	