

**cable lug, terminal end  
FSKI/0,5-1,0/488**

**Weidmüller Interface GmbH & Co. KG**  
 Klingenbergstraße 26  
 D-32758 Detmold  
 Germany  
 Fon: +49 5231 14-0  
 Fax: +49 5231 14-292083  
 www.weidmueller.com



**Insulated tab connector made from PVC with copper sleeve**

- Commercially available designs
- Not soldered
- With conical entry funnel

**General ordering data**

Type	FSKI/0,5-1,0/488
Order No.	<a href="#">1491810000</a>
Version	cable lug, terminal end, Insulated cable connector, 0.5 mm <sup>2</sup>
GTIN (EAN)	4050118301380
Qty.	100 pc(s).

## Data sheet

### cable lug, terminal end FSKI/0,5-1,0/488

**Weidmüller Interface GmbH & Co. KG**  
 Klingenbergstraße 26  
 D-32758 Detmold  
 Germany  
 Fon: +49 5231 14-0  
 Fax: +49 5231 14-292083  
 www.weidmueller.com

## Technical data

### Dimensions and weights

Weight	0.08 g	Net weight	0.804 g
--------	--------	------------	---------

### Environmental Product Compliance

REACH SVHC	Lead 7439-92-1
------------	----------------

### Connectors

Conductor cross-section	0.5 mm <sup>2</sup>	Identification colour	red
Length 1 (l1)	19.8 mm	Material/plastic	PVC
Plug-in density (d3)	0.8 mm	Plug-in width (d2)	4.8 mm

### Classifications

ETIM 6.0	EC000516	ETIM 7.0	EC000516
eClass 9.0	27-44-03-92	eClass 9.1	27-40-02-90
eClass 10.0	27-44-03-92		

### Approvals

ROHS	Conform
------	---------

### Downloads

Brochure/Catalogue	<a href="#">CAT 6 TOOLS 15/16 EN</a>
Engineering Data	<a href="#">EPLAN</a>

**Data sheet**

**cable lug, terminal end  
FSKI/0,5-1,0/488**

**Weidmüller Interface GmbH & Co. KG**  
Klingenbergstraße 26  
D-32758 Detmold  
Germany  
Fon: +49 5231 14-0  
Fax: +49 5231 14-292083  
[www.weidmueller.com](http://www.weidmueller.com)

**Drawings**

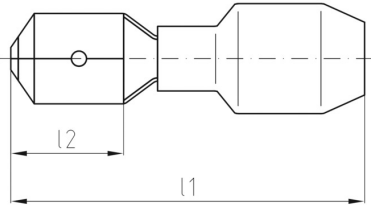

**cable lug, terminal end  
FSKI/0,5-1,0/488**

**Weidmüller Interface GmbH & Co. KG**  
 Klingenbergstraße 26  
 D-32758 Detmold  
 Germany  
 Fon: +49 5231 14-0  
 Fax: +49 5231 14-292083  
 www.weidmueller.com

**Accessories**

**CTI / HTI**



**Crimping tools for insulated connectors**

cable lugs, terminal pins, parallel and serial connectors, plug-in connectors

- Ratchet guarantees precise crimping
- Release option in the event of incorrect operation
- With stop for exact positioning of the contacts.
- Tested to DIN EN 60352 part 2

**General ordering data**

Type	CTI 6	Version
Order No.	<a href="#">9006120000</a>	Pressing tool, Crimping tool for contacts, 0.5mm <sup>2</sup> , 6mm <sup>2</sup> , Oval crimping, Double crimp
GTIN (EAN)	4008190044527	
Qty.	1 pc(s).	
Type	HTI 15	Version
Order No.	<a href="#">9014400000</a>	Pressing tool, Tool for insulated cable connectors, 0.5mm <sup>2</sup> , 2.5mm <sup>2</sup> , Double crimp
GTIN (EAN)	4008190159412	
Qty.	1 pc(s).	
Type	CTI 6 G	Version
Order No.	<a href="#">9202850000</a>	Pressing tool, Tool for insulated cable connectors, 0.5mm <sup>2</sup> , 6mm <sup>2</sup> , Oval crimping, Parallel crimp
GTIN (EAN)	4032248517855	
Qty.	1 pc(s).	