

SAIL-M12GM8SG-4S4.9UIE**Weidmüller Interface GmbH & Co. KG**

Klingenbergstraße 26

D-32758 Detmold

Germany

Fon: +49 5231 14-0

Fax: +49 5231 14-292083

www.weidmueller.com



The most reliable way of achieving connections between two I/O slaves or between the control and one I/O subscriber is by way of pre-assembled cables. The line of cables covers PROFIBUS, CANopen, DeviceNet™, EtherCAT and Ethernet.

General ordering data

Type	SAIL-M12GM8SG-4S4.9UIE
Order No.	1296790490
Version	Bus line, Connecting line, M12 / M8, Number of poles: 4, 4.9 m, Shielded: Yes, LED: No, Sheath material: PUR, Halogen: No
GTIN (EAN)	4050118626452
Qty.	1 pc(s).

Creation date May 3, 2020 12:22:26 AM CEST

Catalogue status 17.04.2020 / We reserve the right to make technical changes.

SAIL-M12GM8SG-4S4.9UIE**Weidmüller Interface GmbH & Co. KG**

Klingenbergstraße 26

D-32758 Detmold

Germany

Fon: +49 5231 14-0

Fax: +49 5231 14-292083

www.weidmueller.com

Technical data**Dimensions and weights**

Net weight 176 g

Environmental Product Compliance

REACH SVHC Lead 7439-92-1

Technical specifications for cable

Number of poles	4	Core cross-section	0.15 mm ²
Outside diameter	4.8 mm ± 0.3 mm	Cable length	4.9 m
Shielded	Yes	Insulation	PP
Colour coding	blue, orange, white / blue, white / orange	Sheath material	PUR
Sheathing colour	green	Halogen	No
Temperature range, stationary	-40...80 °C	Outer cladding in accordance with UL AWM style	20963 (80 °C / 30 V)
Suitable for cable carriers	Yes	Bending radius, min., stationary	4 x cable diameter
Bending radius, min., moving	7.5 x cable diameter	Acceleration	5 m/s ²
Speed	180 m/min	Bending cycles	5 Mio
Resistant to welding beads	No	Hybrid cable	No
Irradiation crosslinked	No	Configurable cable length	No

General technical data

Connection thread	M12 / M8	Housing main material	PUR
Threaded ring material	Brass, nickel-plated	Protection degree	IP67
Contact surface	Gold-plated	LED	No
Rated current	4 A	Insulation strength	10 ⁸ Ω
Temperature range of housing	-25...+80 °C	Plugging cycles	≥ 100
Pollution severity	3	jumpered	No

Classifications

ETIM 6.0	EC002599	ETIM 7.0	EC002599
eClass 9.0	27-06-03-08	eClass 9.1	27-06-03-08
eClass 10.0	27-06-03-08		

Approvals

ROHS Conform

SAIL-M12GM8SG-4S4.9UIE

Weidmüller Interface GmbH & Co. KG
 Klingenbergstraße 26
 D-32758 Detmold
 Germany
 Fon: +49 5231 14-0
 Fax: +49 5231 14-292083
 www.weidmueller.com

Drawings

Dimensioned drawing

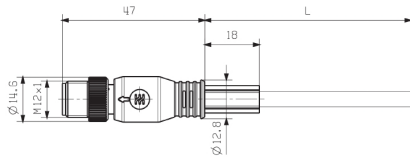

Male, straight

Pole scheme

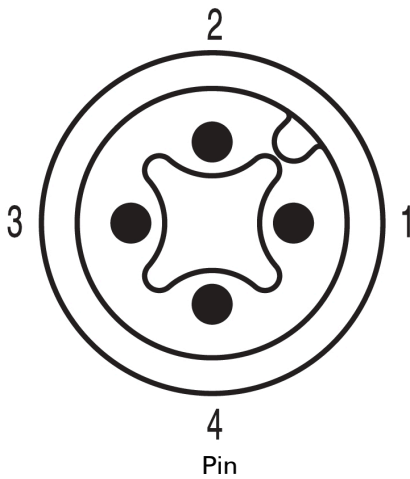

Pin

Wiring diagram

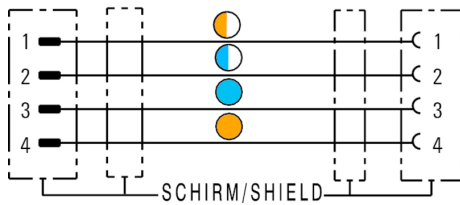

Dimensioned drawing

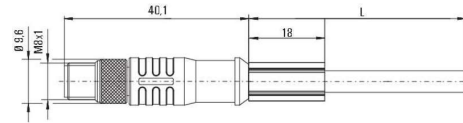

Male, straight

Pole scheme

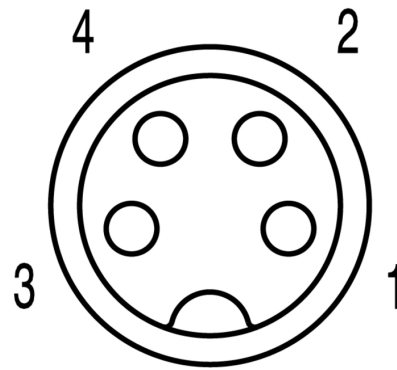

Female

The ideal tool: Screwty® with torque function



Light, securely screwed-in round plug-in connectors. Screwty set DM / VPE: 1 / Order No.: 1920000000 Adapters: M12, M12 F, M8, M8 F