

ClipCard CC 15/49 K MC NE RT

Weidmüller Interface GmbH & Co. KG
Klingenbergstraße 26
D-32758 Detmold
Germany
Fon: +49 5231 14-0
Fax: +49 5231 14-292083
www.weidmueller.com



Similar to illustration



ClipCard device markers in MultiCard format are used for labelling electrical installations and switchgear systems, and offer an interesting alternative to engraving. Thanks to the proven MultiCard format, labelling is possible with PrintJet PRO, the MCP Plus plotter, MCP Basis and MC-Mobilo.

- Highly resistant printing quality when using the PrintJet as a substitute for engraving
- Universal fixing
- Carrier (screwable or with cable ties)
- Tag rail (self-adhesive or screw fixing)
- Or self-adhesive tags

For custom printing: Please send us a file of our labeling software M-Print PRO or M-Print PRO Online (without installation) for your labeling specifications.

Please note that these markers are not intended for printing with the SpeedMarking laser.

General ordering data

Type	CC 15/49 K MC NE RT
Order No.	1288380000
Version	ClipCard, Device markers, 15 x 49 mm, red
GTIN (EAN)	4050118079760
Qty.	40 pc(s).
compatible printer	1324380000 2438520000 2438510000
Alternative product	1877230000

Data sheet

ClipCard CC 15/49 K MC NE RT

Weidmüller Interface GmbH & Co. KG
 Klingenbergstraße 26
 D-32758 Detmold
 Germany
 Fon: +49 5231 14-0
 Fax: +49 5231 14-292083
 www.weidmueller.com

Technical data

Dimensions and weights

Width	49 mm	Width (inches)	1.929 inch
Height	15 mm	Height (inches)	0.591 inch
Depth	1.2 mm	Depth (inches)	0.047 inch
Net weight	3.075 g		

General data

Adhesive	Double-sided adhesive tape	Colour	red
Halogen	No	Material	Polyamide 66
Material colour according to resistance code	2	Operating temperature range	-40...60 °C
Recommended industries	Machinery	UL 94 flammability rating	V-2
Version	Self-adhesive	Width	49 mm

Classifications

ETIM 6.0	EC001288	ETIM 7.0	EC001288
eClass 9.0	27-40-06-29	eClass 9.1	27-40-06-29
eClass 10.0	27-40-06-29		

Approvals

ROHS	Conform
------	---------

Downloads

Engineering Data	EPLAN, WSCAD
Engineering Data	STEP

Data sheet

**ClipCard
CC 15/49 K MC NE RT**

Weidmüller Interface GmbH & Co. KG
Klingenbergstraße 26
D-32758 Detmold
Germany
Fon: +49 5231 14-0
Fax: +49 5231 14-292083
www.weidmueller.com

Drawings

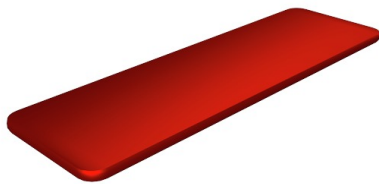

**ClipCard
CC 15/49 K MC NE RT**

Weidmüller Interface GmbH & Co. KG
 Klingenbergstraße 26
 D-32758 Detmold
 Germany
 Fon: +49 5231 14-0
 Fax: +49 5231 14-292083
 www.weidmueller.com

Accessories

Accessories



ClipCard device markers in MultiCard format are used for labelling electrical installations and switchgear systems, and offer an interesting alternative to engraving. Thanks to the proven MultiCard format, labelling is possible with PrintJet PRO, the MCP Plus plotter, MCP Basis and MC-Mobilo.

- Highly resistant printing quality when using the PrintJet as a substitute for engraving
- Universal fixing
- Carrier (screwable or with cable ties)
- Tag rail (self-adhesive or screw fixing)
- Or self-adhesive tags

For custom printing: Please send us a file of our labelling software M-Print PRO or M-Print PRO Online (without installation) for your labelling specifications.

General ordering data

Type	ETO CC 15/49 TRANSPAR.	Version	
Order No.	1880830000	ClipCard, Accessories, 15 x 49 mm, Transparent	
GTIN (EAN)	4032248480906		
Qty.	10 pc(s).		