

**SAIE-M12B-PB-1.0U HW****Weidmüller Interface GmbH & Co. KG**

Klingenbergstraße 26

D-32758 Detmold

Germany

Fon: +49 5231 14-0

Fax: +49 5231 14-292083

www.weidmueller.com



Various build-in connectors are required for the connections on the device side of the sensor/actuator cabling. These are available in the versions M12, M8 and M5.

**General ordering data**

Type	SAIE-M12B-PB-1.0U HW
Order No.	<a href="#">1279480100</a>
Version	Built-in plugs, M12, PG 9, Number of poles: 2
GTIN (EAN)	4050118071481
Qty.	1 pc(s).

Creation date May 2, 2020 10:30:39 PM CEST

Catalogue status 17.04.2020 / We reserve the right to make technical changes.

**SAIE-M12B-PB-1.0U HW****Weidmüller Interface GmbH & Co. KG**

Klingenbergstraße 26

D-32758 Detmold

Germany

Fon: +49 5231 14-0

Fax: +49 5231 14-292083

www.weidmueller.com

**Technical data****Dimensions and weights**

Net weight 82 g

**Environmental Product Compliance**

REACH SVHC Lead 7439-92-1

**General data**

Cable glands	PG 9	Conductor O.D.	-
Connection thread	M12	Contact surface	Gold-plated
Core cross-section	0.25 mm <sup>2</sup>	Housing main material	Zinc diecast, nickel-plated
Material	PUR halogen-free	Number of poles	2
Plugging cycles	≥ 100	Protection degree	IP68
Rated current	4 A	Rated voltage	250 V
Sheathing colour	violet (similar to RAL 4001)	Strand / cable length	1 m
Temperature range of housing	-20 ... +60 °C	Type of connection	Socket connector

**Classifications**

ETIM 6.0	EC002635	ETIM 7.0	EC003570
eClass 9.0	27-44-01-03	eClass 9.1	27-44-01-03
eClass 10.0	27-44-01-03		

**Approvals**

Approvals



ROHS Conform

**Downloads**

Brochure/Catalogue [CAT 8 SAI 15/16 EN](#)  
[FL FIELDWIRING EN](#)

**SAIE-M12B-PB-1.0U HW**

**Weidmüller Interface GmbH & Co. KG**  
Klingenbergstraße 26  
D-32758 Detmold  
Germany  
Fon: +49 5231 14-0  
Fax: +49 5231 14-292083  
[www.weidmueller.com](http://www.weidmueller.com)

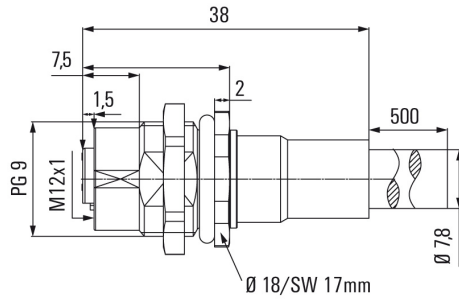
**Drawings****Pole scheme**