

SAIL-M12GM12SG-CD-20A

Weidmüller Interface GmbH & Co. KG

Klingenbergstraße 26

D-32758 Detmold

Germany

Fon: +49 5231 14-0

Fax: +49 5231 14-292083

www.weidmueller.com



The most reliable way of achieving connections between two I/O slaves or between the control and one I/O subscriber is by way of pre-assembled cables. The line of cables covers PROFIBUS, CANopen, DeviceNet™, EtherCAT and Ethernet.

General ordering data

Type	SAIL-M12GM12SG-CD-20A
Order No.	1217042000
Version	Bus line, Connecting line, M12 / M12, Number of poles: 5, 20 m, Shielded: Yes, LED: No, Sheath material: PUR, Halogen: No
GTIN (EAN)	4050118593921
Qty.	1 pc(s).

Creation date May 2, 2020 2:34:00 PM CEST

Catalogue status 17.04.2020 / We reserve the right to make technical changes.

SAIL-M12GM12SG-CD-20A**Weidmüller Interface GmbH & Co. KG**

Klingenbergstraße 26

D-32758 Detmold

Germany

Fon: +49 5231 14-0

Fax: +49 5231 14-292083

www.weidmueller.com

Technical data**Dimensions and weights**

Net weight 1,000 g

Environmental Product Compliance

REACH SVHC Lead 7439-92-1

Technical specifications for cable

Number of poles	5	Wire cross section	2 x 0.34 mm ² + 2 x 0.22 mm ²
Outside diameter	7 mm ± 0.3 mm	Cable length	20 m
Shielded	Yes	Insulation	TPE
Colour coding	white, blue, red, black	Sheath material	PUR
Sheathing colour	black	Halogen	No
Temperature range, moving	-10...80 °C	Temperature range, stationary	-40...80 °C
Outer cladding in accordance with UL AWM style	20236 (80 °C / 30 V)	Suitable for cable carriers	Yes
Bending radius, min., stationary	5 x cable diameter	Bending radius, min., moving	10 x cable diameter
Acceleration	5 m/s ²	Speed	180 m/min
Bending cycles	3 Mio	Resistant to welding beads	No
Hybrid cable	No	Irradiation crosslinked	No
Configurable cable length	No		

General technical data

Connection thread	M12 / M12	Housing main material	PUR
Threaded ring material	Brass, nickel-plated	Coding	A
Protection degree	IP67	Contact surface	Gold-plated
LED	No	Rated voltage	125 V
Rated current	4 A	Insulation strength	10 ⁸ Ω
Temperature range of housing	-25...+80 °C	Tightening torque	M12: 0.8 - 1.2 Nm
Plugging cycles	≥ 100	Pollution severity	3
jumpered	No		

Classifications

ETIM 6.0	EC001855	ETIM 7.0	EC001855
eClass 9.0	27-06-03-11	eClass 9.1	27-06-03-11
eClass 10.0	27-06-03-11		

Approvals

ROHS Conform

DownloadsEngineering Data [STEP](#)

SAIL-M12GM12SG-CD-20A

Weidmüller Interface GmbH & Co. KG
 Klingenbergstraße 26
 D-32758 Detmold
 Germany
 Fon: +49 5231 14-0
 Fax: +49 5231 14-292083
 www.weidmueller.com

Drawings

Dimensioned drawing

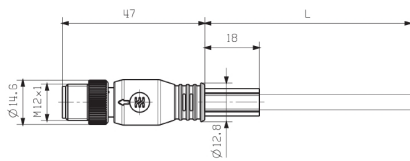

Dimensioned drawing

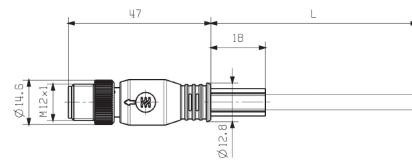

Stift gerade

Pole scheme

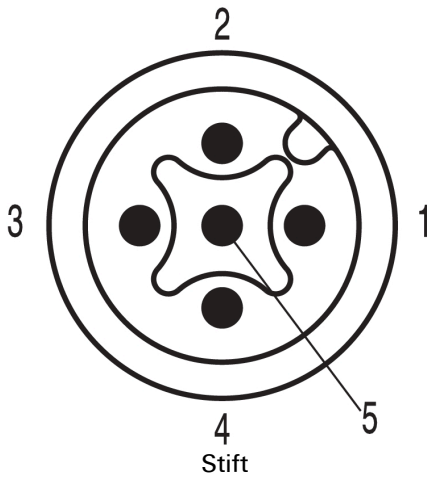

Pole scheme

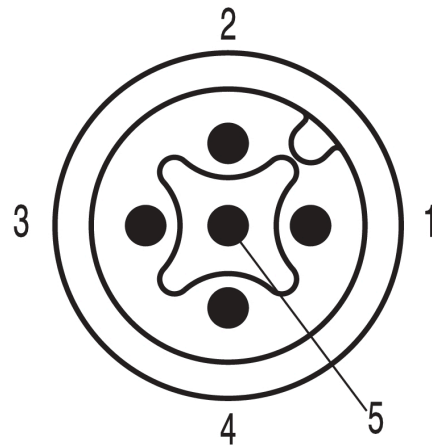

Wiring diagram

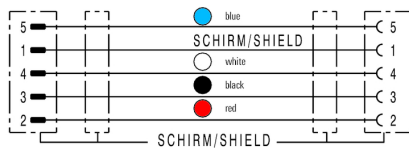

The ideal tool: Screwty® with torque function



Light, securely screwed-in round plug-in connectors. Screwty set DM / VPE: 1 / Order No.: 1920000000 Adapters: M12, M12 F, M8, M8 F