

## FBCEX PA M12 MA-FM 1M

**Weidmüller Interface GmbH & Co. KG**

Klingenbergstraße 26

D-32758 Detmold

Germany

Fon: +49 5231 14-0

Fax: +49 5231 14-292083

www.weidmueller.com



The most reliable way of achieving connections between two I/O slaves or between the control and one I/O subscriber is by way of pre-assembled cables. The line of cables covers PROFIBUS, CANopen, DeviceNet™, EtherCAT and Ethernet.

### General ordering data

Type	FBCEX PA M12 MA-FM 1M
Order No.	<a href="#">1075450100</a>
Version	Bus line, Connecting line, M12 / M12, Number of poles: 2, 1 m, pin, angled - bush straight, Shielded: Yes, LED: No, Sheath material: PVC, Halogen: Yes
GTIN (EAN)	4032248833924
Qty.	1 pc(s).

Creation date May 1, 2020 4:39:18 PM CEST

Catalogue status 17.04.2020 / We reserve the right to make technical changes.

**FBCEX PA M12 MA-FM 1M**
**Weidmüller Interface GmbH & Co. KG**

Klingenbergstraße 26

D-32758 Detmold

Germany

Fon: +49 5231 14-0

Fax: +49 5231 14-292083

www.weidmueller.com

**Technical data**
**Dimensions and weights**

Net weight	108 g
------------	-------

**Environmental Product Compliance**

REACH SVHC	Lead 7439-92-1
------------	----------------

**Technical specifications for cable**

Number of poles	2	Core cross-section	1 mm <sup>2</sup>
Outside diameter	8 mm ± 0.4 mm	Cable length	1 m
Shielded	Yes	Insulation	PE
Colour coding	red, green	Sheath material	PVC
Sheathing colour	blue (RAL 5015)	Halogen	Yes
Temperature range, moving	-5...60 °C	Temperature range, stationary	-30...80 °C
Suitable for cable carriers	No	Bending radius, min., stationary	8 x Kabeldurchmesser
Bending radius, min., moving	8 x Kabeldurchmesser	Resistant to welding beads	No
Hybrid cable	No	Irradiation crosslinked	No
Configurable cable length	No		

**General technical data**

Version	pin, angled - bush straight	Connection thread	M12 / M12
Housing main material	PUR	Threaded ring material	Brass, nickel-plated
Coding	A	Protection degree	IP67
Contact surface	Gold-plated	LED	No
Rated voltage	100 V	Insulation strength	10 <sup>8</sup> Ω
Temperature range of housing	-25...+80 °C	Tightening torque	M12: 0.8 - 1.2 Nm
Plugging cycles	≥ 100	Pollution severity	3
jumpered	No		

**Classifications**

ETIM 6.0	EC002599	ETIM 7.0	EC002599
eClass 9.0	27-06-03-08	eClass 9.1	27-06-03-08
eClass 10.0	27-06-03-08		

**Approvals**

ROHS	Conform
------	---------

**Downloads**

Brochure/Catalogue	<a href="#">CAT 8 SAI 15/16 EN</a> <a href="#">FL FIELDWIRING EN</a>
Engineering Data	<a href="#">EPLAN.WSCAD</a>

**FBCEX PA M12 MA-FM 1M**

**Weidmüller Interface GmbH & Co. KG**  
 Klingenbergstraße 26  
 D-32758 Detmold  
 Germany  
 Fon: +49 5231 14-0  
 Fax: +49 5231 14-292083  
 www.weidmueller.com

**Drawings**

**Dimensioned drawing**

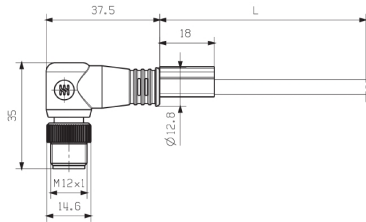

Male, angled

**Pole scheme**

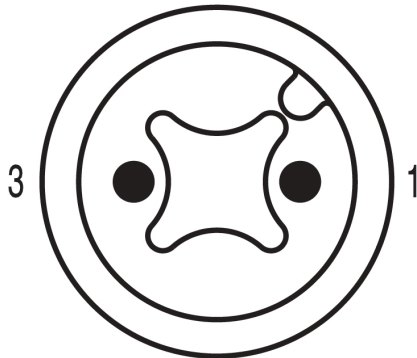

Pin

**Dimensioned drawing**

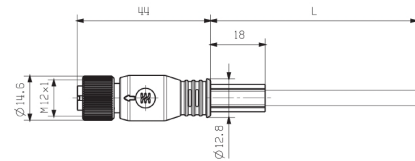

Straight socket

**Pole scheme**

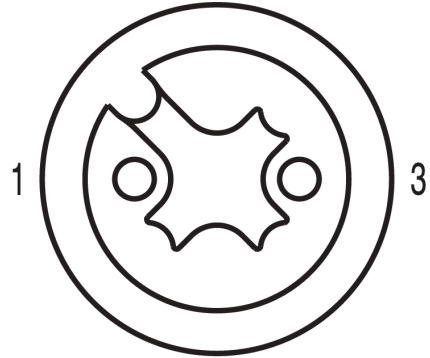

Socket

**Wiring diagram**

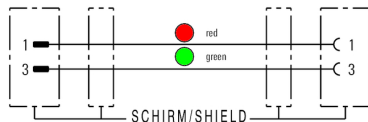

**The ideal tool: Screwty® with torque function**



Light, securely screwed-in round plug-in connectors. Screwty set DM / VPE: 1 / Order No.: 1920000000 Adapters: M12, M12 F, M8, M8 F