

SAIL-M12GM12G-PB-10E

Weidmüller Interface GmbH & Co. KG

Klingenbergstraße 26

D-32758 Detmold

Germany

Fon: +49 5231 14-0

Fax: +49 5231 14-292083

www.weidmueller.com



The most reliable way of achieving connections between two I/O slaves or between the control and one I/O subscriber is by way of pre-assembled cables. The line of cables covers PROFIBUS, CANopen, DeviceNet™, EtherCAT and Ethernet.

General ordering data

Type	SAIL-M12GM12G-PB-10E
Order No.	1058571000
Version	Bus line, Connecting line, M12 / M12, Number of poles: 2, 10 m, pin, straight - socket, straight, Shielded: Yes, LED: No, Sheath material: PVC, Halogen: Yes
GTIN (EAN)	4032248800223
Qty.	1 pc(s).

Creation date May 1, 2020 12:49:13 PM CEST

Catalogue status 17.04.2020 / We reserve the right to make technical changes.

SAIL-M12GM12G-PB-10E**Weidmüller Interface GmbH & Co. KG**

Klingenbergstraße 26

D-32758 Detmold

Germany

Fon: +49 5231 14-0

Fax: +49 5231 14-292083

www.weidmueller.com

Technical data**Dimensions and weights**

Net weight 646 g

Environmental Product Compliance

REACH SVHC Lead 7439-92-1

Technical specifications for cable

Number of poles	2	Wire cross section	PUR 0.25 mm ² / PVC 0.34 mm ²
Outside diameter	7.8 mm ± 0.2 mm	Cable length	10 m
Shielded	Yes	Insulation	PVC
Colour coding	red, green	Sheath material	PVC
Sheathing colour	violet	Halogen	Yes
Temperature range, moving	-5...60 °C	Temperature range, stationary	-20...70 °C
Suitable for cable carriers	No	Bending radius, min., stationary	18 x cable diameter
Bending radius, min., moving	9 x cable diameter	Resistant to welding beads	No
Hybrid cable	No	Irradiation crosslinked	No
Configurable cable length	No		

General technical data

Version	pin, straight - socket, straight	Connection thread	M12 / M12
Housing main material	PUR	Threaded ring material	Brass, nickel-plated
Coding	B	Protection degree	IP67
Contact surface	Gold-plated	LED	No
Rated voltage	250 V	Rated current	4 A
Insulation strength	10 ⁸ Ω	Temperature range of housing	-25...+80 °C
Tightening torque	M12: 0.8 - 1.2 Nm	Plugging cycles	≥ 100
Pollution severity	3	Plugging cycles jumpered	No

Standards

Certificate no. (cULus) E307231

Classifications

ETIM 6.0	EC002599	ETIM 7.0	EC002599
eClass 9.0	27-06-03-08	eClass 9.1	27-06-03-08
eClass 10.0	27-06-03-08		

Approvals

Approvals



ROHS Conform

SAIL-M12GM12G-PB-10E

Weidmüller Interface GmbH & Co. KG
Klingenbergstraße 26
D-32758 Detmold
Germany
Fon: +49 5231 14-0
Fax: +49 5231 14-292083
www.weidmueller.com

Technical data**Downloads**

Brochure/Catalogue	FL FIELDWIRING EN
Engineering Data	EPLAN, WSCAD

SAIL-M12GM12G-PB-10E

Weidmüller Interface GmbH & Co. KG
 Klingenbergstraße 26
 D-32758 Detmold
 Germany
 Fon: +49 5231 14-0
 Fax: +49 5231 14-292083
 www.weidmueller.com

Drawings

Dimensioned drawing

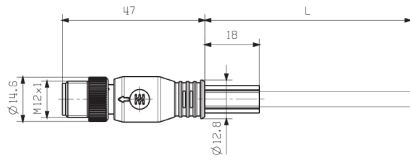

Male, straight

Pole scheme



Pin

Dimensioned drawing

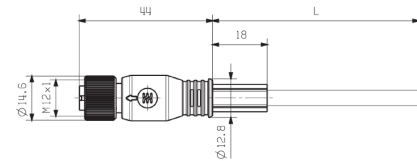

Straight socket

Pole scheme

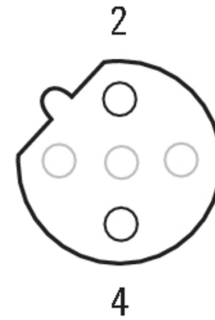

Socket

Wiring diagram

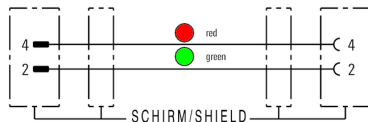

The ideal tool: Screwty® with torque function



Light, securely screwed-in round plug-in connectors. Screwty set DM / VPE: 1 / Order No.: 1920000000 Adapters: M12, M12 F, M8, M8 F