

SAIL-M12GM12G-PB-1.5E

Weidmüller Interface GmbH & Co. KG

Klingenbergstraße 26

D-32758 Detmold

Germany

Fon: +49 5231 14-0

Fax: +49 5231 14-292083

www.weidmueller.com



The most reliable way of achieving connections between two I/O slaves or between the control and one I/O subscriber is by way of pre-assembled cables. The line of cables covers PROFIBUS, CANopen, DeviceNet™, EtherCAT and Ethernet.

General ordering data

| | |
|------------|---|
| Type | SAIL-M12GM12G-PB-1.5E |
| Order No. | 1058570150 |
| Version | Bus line, Connecting line, M12 / M12, Number of poles: 2, 1.5 m, pin, straight - socket, straight, Shielded: Yes, LED: No, Sheath material: PVC, Halogen: Yes |
| GTIN (EAN) | 4032248800193 |
| Qty. | 1 pc(s). |

Creation date May 1, 2020 12:48:17 PM CEST

Catalogue status 17.04.2020 / We reserve the right to make technical changes.

SAIL-M12GM12G-PB-1.5E**Weidmüller Interface GmbH & Co. KG**

Klingenbergstraße 26

D-32758 Detmold

Germany

Fon: +49 5231 14-0

Fax: +49 5231 14-292083

www.weidmueller.com

Technical data**Dimensions and weights**

Net weight 120 g

Environmental Product Compliance

REACH SVHC Lead 7439-92-1

Technical specifications for cable

| | | | |
|------------------------------|--------------------|----------------------------------|---|
| Number of poles | 2 | Wire cross section | PUR 0.25 mm ² / PVC 0.34 mm ² |
| Outside diameter | 7.8 mm ± 0.2 mm | Cable length | 1.5 m |
| Shielded | Yes | Insulation | PVC |
| Colour coding | red, green | Sheath material | PVC |
| Sheathing colour | violet | Halogen | Yes |
| Temperature range, moving | -5...60 °C | Temperature range, stationary | -20...70 °C |
| Suitable for cable carriers | No | Bending radius, min., stationary | 18 x cable diameter |
| Bending radius, min., moving | 9 x cable diameter | Resistant to welding beads | No |
| Hybrid cable | No | Irradiation crosslinked | No |
| Configurable cable length | No | | |

General technical data

| | | | |
|-----------------------|----------------------------------|------------------------------|----------------------|
| Version | pin, straight - socket, straight | Connection thread | M12 / M12 |
| Housing main material | PUR | Threaded ring material | Brass, nickel-plated |
| Coding | B | Protection degree | IP67 |
| Contact surface | Gold-plated | LED | No |
| Rated voltage | 250 V | Rated current | 4 A |
| Insulation strength | 10 ⁸ Ω | Temperature range of housing | -25...+80 °C |
| Tightening torque | M12: 0.8 - 1.2 Nm | Plugging cycles | ≥ 100 |
| Pollution severity | 3 | jumpered | No |

Standards

Certificate no. (cULus) E307231

Classifications

| | | | |
|-------------|-------------|------------|-------------|
| ETIM 6.0 | EC002599 | ETIM 7.0 | EC002599 |
| eClass 9.0 | 27-06-03-08 | eClass 9.1 | 27-06-03-08 |
| eClass 10.0 | 27-06-03-08 | | |

Approvals

Approvals



ROHS Conform

SAIL-M12GM12G-PB-1.5E

Weidmüller Interface GmbH & Co. KG
Klingenbergstraße 26
D-32758 Detmold
Germany
Fon: +49 5231 14-0
Fax: +49 5231 14-292083
www.weidmueller.com

Technical data**Downloads**

| | |
|--------------------|---|
| Brochure/Catalogue | CAT 8 SAI 15/16 EN FL FIELDWIRING EN |
| Engineering Data | EPLAN, WSCAD |

SAIL-M12GM12G-PB-1.5E

Weidmüller Interface GmbH & Co. KG
 Klingenbergstraße 26
 D-32758 Detmold
 Germany
 Fon: +49 5231 14-0
 Fax: +49 5231 14-292083
 www.weidmueller.com

Drawings

Dimensioned drawing

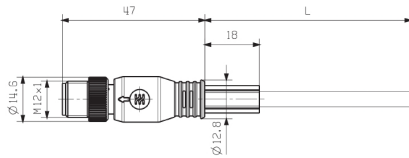

Male, straight

Pole scheme



Pin

Dimensioned drawing

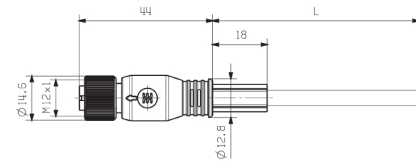

Straight socket

Pole scheme

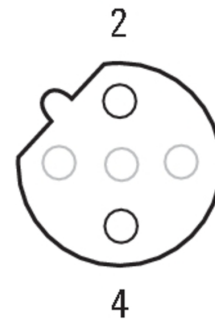

Socket

Wiring diagram

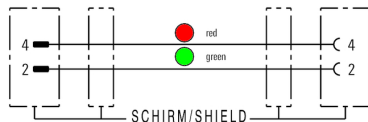

The ideal tool: Screwty® with torque function



Light, securely screwed-in round plug-in connectors. Screwty set DM / VPE: 1 / Order No.: 1920000000 Adapters: M12, M12 F, M8, M8 F