

## SAIL-M12GM12G-4-4.0T

**Weidmüller Interface GmbH & Co. KG**

Klingenbergstraße 26

D-32758 Detmold

Germany

Fon: +49 5231 14-0

Fax: +49 5231 14-292083

www.weidmueller.com



Sensor/actuator cables are used for wiring sensors and actuators and for transmitting data or power in various applications. The moulded cable offers connected and tested connection of the plug-in connector to the cable ex-works. The cables may be exposed to a wide range of conditions, such as humidity, dust, heat, cold, shock or vibration.

Our developers have focused specifically on this issue and designed a host of different M8 and M12 sensor-actuator cables so you are bound to find the solution you need for your application.

Is there something you have not managed to find or you feel needs explanation? Talk to us!

### General ordering data

|            |  |
|------------|--|
| Type       | SAIL-M12GM12G-4-4.0T   |
| Order No.  | <a href="#">1021730400</a>   |
| Version    | Sensor/actuator line, Connecting line, M12 / M12, Number of poles : 4, 4 m, Shielded: No, LED: No, Sheath material: PUR, Halogen: No |
| GTIN (EAN) | 4050118510249  |
| Qty.       | 1 pc(s).   |

Creation date May 1, 2020 7:09:18 AM CEST

Catalogue status 17.04.2020 / We reserve the right to make technical changes.

**SAIL-M12GM12G-4-4.0T****Weidmüller Interface GmbH & Co. KG**

Klingenbergstraße 26

D-32758 Detmold

Germany

Fon: +49 5231 14-0

Fax: +49 5231 14-292083

www.weidmueller.com

**Technical data****Dimensions and weights**

Net weight 150 g

**Environmental Product Compliance**

REACH SVHC Lead 7439-92-1

**Technical specifications for cable**

|  |                           |                                  |                      |
|--|---------------------------|----------------------------------|----------------------|
| Number of poles                                | 4                         | Core cross-section               | 0.34 mm <sup>2</sup> |
| Outside diameter                               | 4.9 mm ± 0.2 mm           | Cable length                     | 4 m                  |
| Shielded                                       | No                        | Insulation                       | PP                   |
| Colour coding                                  | brown, white, blue, black | Sheath material                  | PUR                  |
| Sheathing colour                               | black                     | Halogen                          | No                   |
| Temperature range, moving                      | -30...105 °C              | Temperature range, stationary    | -40...105 °C         |
| Outer cladding in accordance with UL AWM style | 20233 (80 °C / 300 V)     | Suitable for cable carriers      | Yes                  |
| Torsion resistance                             | 360 °/m                   | Bending radius, min., stationary | 4 x cable diameter   |
| Bending radius, min., moving                   | 7.5 x cable diameter      | Acceleration                     | 5 m/s <sup>2</sup>   |
| Speed  | 200 m/min                 | Bending cycles                   | 10 Mio               |
| Resistant to welding beads                     | Yes                       | Configurable cable length        | No                   |

**General technical data**

|                       |                   |                              |   |
|-----------------------|-------------------|------------------------------|---|
| AF size               | 12 mm             | Connection thread            | M12 / M12                               |
| Housing main material | PUR               | Threaded ring material       | Diecast zinc                            |
| Coding                | A                 | Protection degree            | IP65, IP66, IP67, IP68, when screwed in |
| Contact surface       | Gold-plated       | LED                          | No                                      |
| Rated voltage         | 250 V             | Rated current                | 4 A                                     |
| Insulation strength   | 10 <sup>8</sup> Ω | Temperature range of housing | -25...+80 °C                            |
| Tightening torque     | M12: 0.8 - 1.2 Nm | Plugging cycles              | ≥ 100                                   |
| Pollution severity    | 3                 | jumpered                     | No                                      |

**Standards**

Certificate no. (cULus) E307231

**Classifications**

|             |             |            |             |
|-------------|-------------|------------|-------------|
| ETIM 6.0    | EC001855    | ETIM 7.0   | EC001855    |
| eClass 9.0  | 27-06-03-11 | eClass 9.1 | 27-06-03-11 |
| eClass 10.0 | 27-06-03-11 |            |             |

**Approvals**

Approvals



ROHS

Conform

**SAIL-M12GM12G-4-4.0T**

**Weidmüller Interface GmbH & Co. KG**  
Klingenbergstraße 26  
D-32758 Detmold  
Germany  
Fon: +49 5231 14-0  
Fax: +49 5231 14-292083  
www.weidmueller.com

**Technical data****Downloads**

---

|                             |   |
|-----------------------------|---|
| Brochure/Catalogue          | <a href="#">FL FIELDWIRING EN</a>   |
| Engineering Data            | <a href="#">STEP</a>  |
| Product Change Notification | <a href="#">DE - Technische Änderung zu M12 Gewinding mit 6-Kant</a><br><a href="#">EN - Technical change to M12 nut with additional hexagonal mounting</a> |

---

**SAIL-M12GM12G-4-4.0T**

**Weidmüller Interface GmbH & Co. KG**  
 Klingenbergstraße 26  
 D-32758 Detmold  
 Germany  
 Fon: +49 5231 14-0  
 Fax: +49 5231 14-292083  
 www.weidmueller.com

**Drawings**

**Dimensioned drawing**

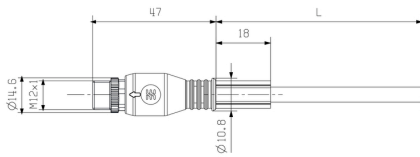

Male, straight

**Pole scheme**

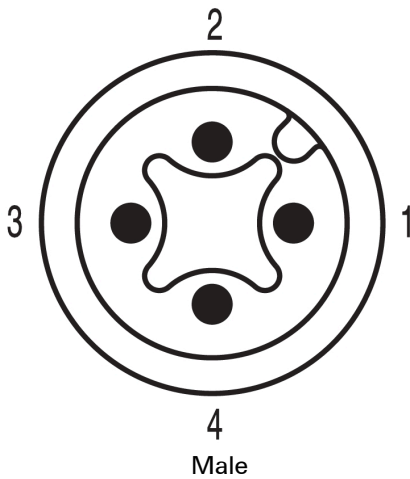

**Dimensioned drawing**

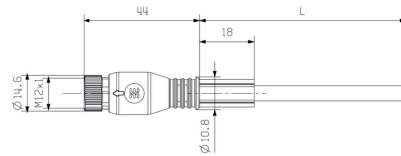

Straight socket

**Pole scheme**

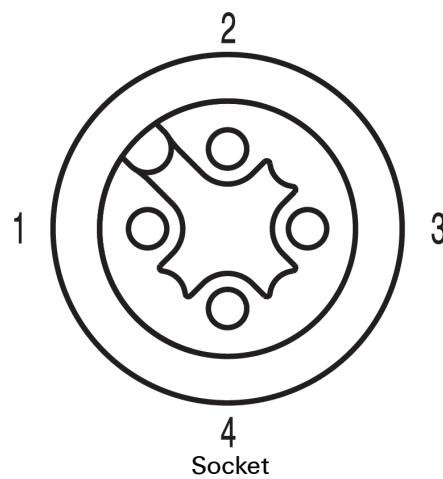

**Wiring diagram**

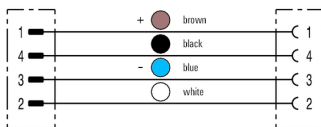

**The ideal tool: Screwty® with torque function**



Light, securely screwed-in round plug-in connectors. Screwty set DM / VPE: 1 / Order No.: 1920000000 Adapters: M12, M12 F, M8, M8 F