

Data sheet | Item number: 893-1606

T-distribution connector; 2-pole; Cod. E; 1 input; 2 outputs; green

www.wago.com/893-1606

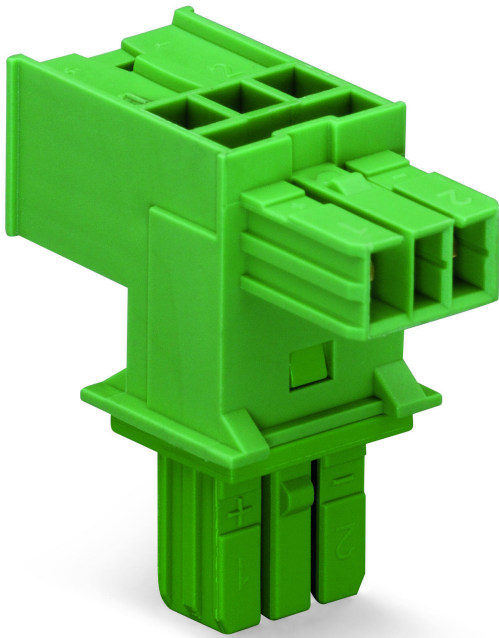

RoHS Compliant

BOMcheck.net

Color:

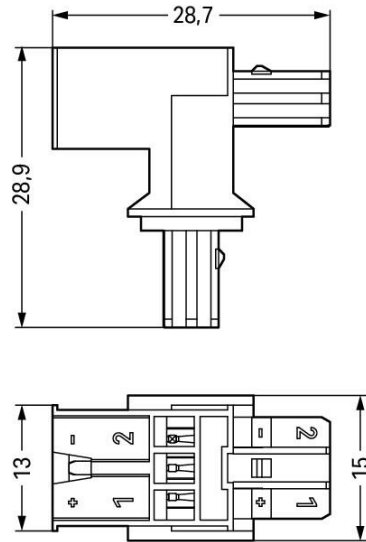

Item description

- For low voltages up to 50 V
- Compact size, standardized interface
- Available in two different custom coding options with mismatching protection

Note:

All connectors for mounted installations (snap-in versions for lighting fixtures or devices, all types of PCB and distribution connectors) are factory-

Subject to changes. Please also observe the further product documentation!

WAGO Kontakttechnik GmbH & Co. KG
Hansastr. 27
32423 Minden
Phone: +49571 887-0 | Fax: +49571 887-169
Email: info.de@wago.com | Web: www.wago.com

Do you have any questions about our products?
We are always happy to take your call at +49 (571) 887-44222.



equipped with locking levers to ensure plugs and sockets are securely locked. Additional locking levers are only required for flying leads (plug /socket).

Note on mismatching protection:

All WINSTA[®] components are 100% protected against mismatching when:

- a.) plugging different numbers of poles
- b.) plugging while rotated 180
- c.) plugging while laterally staggered
- d.) plugging one pole

Data

Electrical data

Note on Contact Resistance

approx. 3mΩ contact resistance

Ratings per IEC/EN 60664-1

Ratings per	IEC/EN 60664-1
Rated voltage (III / 3)	50 V
Rated impulse voltage (III / 3)	0.8 kV
Rated current	3 A
Legend (ratings)	(III / 3) ± Overvoltage category III / Pollution degree 3

Connection data

No. of poles	2
Total number of potentials	2

Geometrical Data

Width	15 mm / 0.591 inch
Height	28,9 mm / 1.138 inch
Depth	28,7 mm / 1.13 inch

Mechanical data

Technologie	KNX
Coding	E
Mating force of a plug-in connection	approx. 10 ... 15 N
Retention force of a plug-in connection	When locked: > 80 N

Subject to changes. Please also observe the further product documentation!

WAGO Kontakttechnik GmbH & Co. KG
Hansastr. 27
32423 Minden
Phone: +49571 887-0 | Fax: +49571 887-169
Email: info.de@wago.com | Web: www.wago.com

Do you have any questions about our products?
We are always happy to take your call at +49 (571) 887-44222.



Unmating force of a plug-in connection	when unlocked: approx. 15 ... 20 N
Number of mating cycles	200
Type of distribution connector	T-distribution connector
Marking	1+ 2-
Protection class	IP20
Note on protection class	Only when mated and secured with a strain relief housing (These compact connectors are not designed for use in open, easily accessible areas.)
Potential marking	1+ 2-
Application	KNX

Plug connection

Contact type (pluggable connector)	Socket/plug
Mismating protection	Yes
Locking of plug-in connection	locking lever
Locking lever	yes

Material Data

Color	green
Insulating material	Polyamide 66 (PA 66)
Contact material	Copper alloy (surface-treated)
Weight	3.3 g

Environmental Requirements

Processing temperature	-5 ... +40 °C
Continuous operating temperature	-35 ... +85 °C
Note on Continuous Service Temperature	Insulating parts for temperatures ≤ 105 °C

Commercial data

Product Group	20 (WINSTA)
Packaging type	BOX
Country of origin	DE
GTIN	4045454547677
Customs Tariff No.	85366990990

Subject to changes. Please also observe the further product documentation!

WAGO Kontakttechnik GmbH & Co. KG
Hansastr. 27
32423 Minden
Phone: +49571 887-0 | Fax: +49571 887-169
Email: info.de@wago.com | Web: www.wago.com

Do you have any questions about our products?
We are always happy to take your call at +49 (571) 887-44222.

Counterpart



Item no.893-1002

Socket; with strain relief housing; 2-pole; Cod. E; green

www.wago.com/893-1002

Item no.893-1012

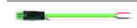
Plug; with strain relief housing; 2-pole; Cod. E; green

www.wago.com/893-1012

Item no.894-8992/133-106

pre-assembled connecting cable; Eca; Socket/open-ended; 2-pole; Cod. E; J-Y(ST)Y...LG 2x2x0.8; 1 m; green

www.wago.com/894-8992/133-106

Item no.894-8992/033-106

pre-assembled interconnecting cable; Eca; Socket/plug; 2-pole; Cod. E; J-Y(ST)Y...LG 2x2x0.8; 1 m; green

www.wago.com/894-8992/033-106

Item no.894-8992/233-106

pre-assembled connecting cable; Eca; Plug/open-ended; 2-pole; Cod. E; J-Y(ST)Y...LG 2x2x0.8; 1 m; green

www.wago.com/894-8992/233-106

Downloads

CAD/CAE-Data

CAD data

2D/3D Models 893-1606

URL

Download

CAE data

WSCAD Universe 893-1606

URL

Download

Installation Notes

Product family

<i>WINSTA</i>® KNX

[Show all products from the family](#)

Subject to changes. Please also observe the further product documentation!

WAGO Kontakttechnik GmbH & Co. KG

Hansastr. 27

32423 Minden

Phone: +49571 887-0 | Fax: +49571 887-169

 Email: info.de@wago.com | Web: www.wago.com

Do you have any questions about our products?

We are always happy to take your call at +49 (571) 887-44222.