

Flush-type connector - SACCBP-MS-8CON-M16/3,0-PUR SCO - 1067293

Please be informed that the data shown in this PDF Document is generated from our Online Catalog. Please find the complete data in the user's documentation. Our General Terms of Use for Downloads are valid (<http://phoenixcontact.com/download>)

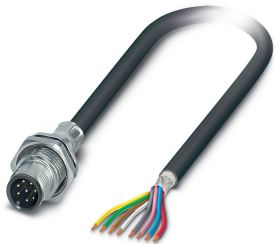

Flush-type plug, shielded, 8-pos., M12, A-coded, rear/screw mounting with M16 thread, with 2 m cable, 8 x 0.25 mm²

Your advantages

- ✓ Pre-assembled with cables in various standard lengths for immediate use
- ✓ Customer-specific assemblies and cable lengths can be supplied
- ✓ Sealed on the cable side for optimum tightness of seal
- ✓ For high transmission safety: shield connection to the housing with optional EMC nut



Key Commercial Data

Packing unit	1
GTIN	 4 055626 735832
GTIN	4055626735832
Custom tariff number	85444290

Technical data

Environmental Product Compliance

REACH SVHC	Lead 7439-92-1
China RoHS	Environmentally Friendly Use Period = 50 years
	For details about hazardous substances go to tab "Downloads", Category "Manufacturer's declaration"

Drawings

Flush-type connector - SACCBP-MS-8CON-M16/3,0-PUR SCO - 1067293

Dimensional drawing

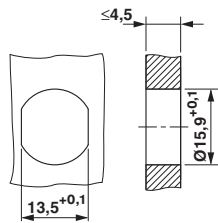

Schematic diagram

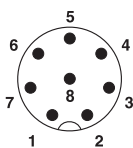

Pin assignment of M12 male connector, 8-pos., A-coded, view of socket side

Housing cutout for M16 fastening thread, mounting panel with feed-through hole (alternatively with surface as protection against rotation)

Cable cross section



PUR halogen-free black [PUR]

Dimensional drawing

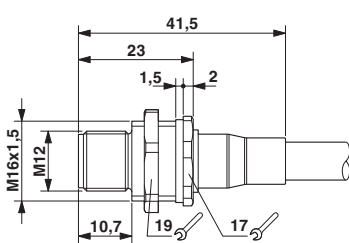

M12 flush-type connector

Circuit diagram

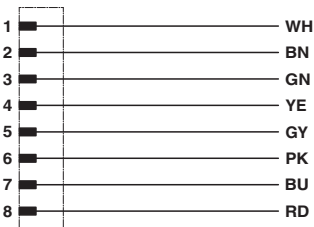

Contact assignment of the M12 plugs

Classifications

eCl@ss

eCl@ss 10.0.1	27440102
eCl@ss 11.0	27440102
eCl@ss 9.0	27440102



Flush-type connector - SACCBP-MS-8CON-M16/3,0-PUR SCO - 1067293

Classifications

ETIM

ETIM 6.0	EC002061
----------	----------

Approvals

Approvals

Approvals

EAC

Ex Approvals

Approval details

EAC		B.01687
-----	---	---------