

## Set - EV-SET-T2AC-BAS-RCM1-20ASE12 - 1628080

Please be informed that the data shown in this PDF Document is generated from our Online Catalog. Please find the complete data in the user's documentation. Our General Terms of Use for Downloads are valid (<http://phoenixcontact.com/download>)



CHARX start home, Starter kit for easy assembly of a charging station, Integrated release function of the locking actuator for disconnection of Infrastructure Plug and Infrastructure Socket Outlet, IEC 62196-2, IEC 61851-1, Mode 3, Case B, 11 kW, 16 A, 400 V AC, cable: 0.7 m

### Product Description

HOME charging technology set with AC Infrastructure Socket Outlet, with sample assembly and installation instructions for a charging station for E-Mobility (EVSE), including recommendations for further components required (charging contactor, safety equipment), for charging electric vehicles (EV) with alternating current (AC) via Type 2 Vehicle Inlets

### Your advantages

- ✔ Set of all Phoenix Contact charging technology products and terminal blocks with recommendations for further components required (charging contactor, safety equipment)
- ✔ Convenient ordering, thanks to just one order number for the set, saving you the job of putting together matching components
- ✔ Certified in accordance with IATF 16949:2016 and ISO 9001:2015
- ✔ Safe use, thanks to verified instructions regarding compatible components
- ✔ Stand-alone and simple setup of an AC charging station without additional development effort based on a wiring diagram
- ✔ Flexible application options, thanks to comprehensive configuration options and various communication interfaces for the charging controller

### Key Commercial Data

Packing unit	1
GTIN	 4 055626 379074
GTIN	4055626379074
Custom tariff number	85366990

### Technical data

#### Product definition

Type	Starter kit
Application	for easy assembly of a charging station
Standards/regulations	IEC 62196-2
	IEC 61851-1
Charging standard	Type 2
Charging mode	Mode 3, Case B

## Set - EV-SET-T2AC-BAS-RCM1-20ASE12 - 1628080

### Technical data

#### Product definition

Number of supported charging points	1
Locking release in the event of mains failure	Integrated release function of the locking actuator for disconnection of Infrastructure Plug and Infrastructure Socket Outlet
Note	Set of all Phoenix Contact charging technology products and terminal blocks with recommendations for further components required (charging contactor, safety equipment)
	The installation and startup of this device may only be performed by an electrically skilled person. Observe the applicable national standards and regulations.
	The individual components bear a CE marking if legally required.

#### Dimensions

Conductor length	0.70 m
Cable length of locking actuator	0.50 m

#### Electrical properties

Type of charging current	AC 3-phase
Charging power	11 kW
Charge current	16 A
Charging voltage	400 V AC

#### Charging technology set

Type of charging point	AC infrastructure socket outlet, 12 V locking actuator, self-closing IP54 protective cover
Charging controller	Basic AC charging controller, preconfigured
Locking release in the event of mains failure	Integrated release function of the locking actuator for disconnection of Infrastructure Plug and Infrastructure Socket Outlet
Residual current monitoring module	1-channel RCM
Wiring diagram	Including download of sample E-Plan
Set consists of	1405213 EV-T2M3SE12-3AC20A-0,7M2,5E10
	1405217 EV-T2SC
	1622452 EV-CC-AC1-M3-CBC-SER-HS
	1622450 EV-RCM-C1-AC30-DC6
	3208760 PT 16-TWIN N
	3208773 PT 16-TWIN N BU
	3208786 PT 16-TWIN N-PE
	3211813 PT 6
	3211819 PT 6 BU
	3211822 PT 6-PE
	3209510 PT 2,5
	3209549 PT 2,5-TWIN

# Set - EV-SET-T2AC-BAS-RCM1-20ASE12 - 1628080

## Technical data

### Charging technology set

	3209552 PT 2,5-TWIN BU
	3025040 ZFK 6-DREHSI (5X20)
	3005950 FBS 2-12
	3030174 FBS 3-5
	3030417 D-ST 2,5
	3030488 D-ST 2,5-TWIN
	3212044 D-PT 6
	3208799 D-PT 16-TWIN N
	3022276 CLIPFIX 35-5

### Environmental Product Compliance

REACH SVHC	Lead 7439-92-1
China RoHS	Environmentally Friendly Use Period = 50 years
	For details about hazardous substances go to tab "Downloads", Category "Manufacturer's declaration"

## Drawings

Connection diagram

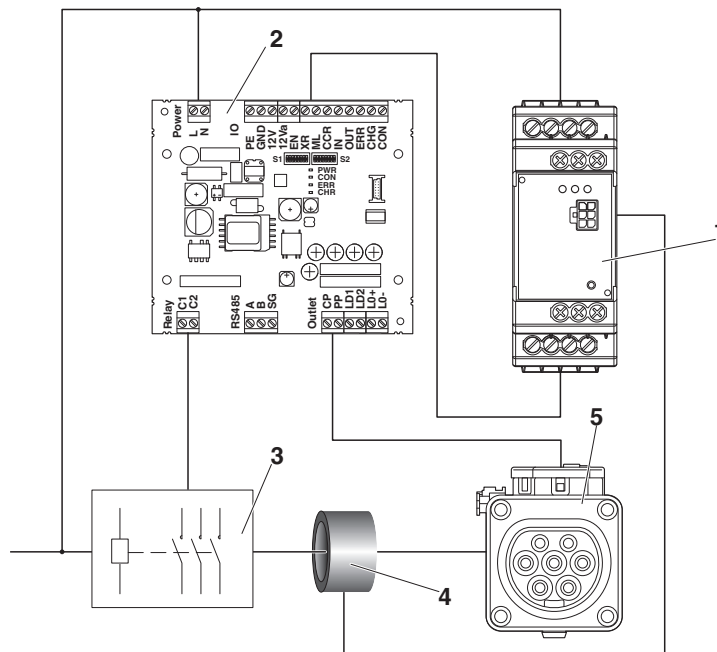

Connection drawing:

## Set - EV-SET-T2AC-BAS-RCM1-20ASE12 - 1628080

1. RCM, 2. Charging controller, 3. Charging contactor, 4. RCM sensor coil, 5. Infrastructure socket outlet

### Articles in set

#### Socket Outlet - EV-T2M3SE12-3AC20A-0,7M2,5E10 - 1405213



CHARX connect, Socket Outlet, rear protective cover screw connection, For charging electric vehicles (EV) with alternating current (AC), Compatible with infrastructure charging plugs, Type 2, IEC 62196-2, 20 A / 480 V (AC), Single wires, length: 0.7 m, Locking actuator: 12 V, 4-position, Rear panel mounting, Generation 1, "PHOENIX CONTACT" logo

#### Protective covers - EV-T2SC - 1405217



CHARX connect, Protective covers, self-closing, rear protective cover screw connection, For attaching to infrastructure charging sockets, Type 2, IEC 62196-2, Front mounting, M5 thread, Generation 1, Embossed PHOENIX CONTACT logo

#### AC charging controller - EV-CC-AC1-M3-CBC-SER-HS - 1622452



The EV-CC-AC1-M3-CBC-SER-HS charging controller with housing for DIN rail mounting is used for charging electric vehicles at 3-phase AC networks according to IEC 61851-1, Mode 3. All charging functions, comprehensive configuration settings as well as a locking controller are already integrated.

#### Differential current monitoring - EV-RCM-C1-AC30-DC6 - 1622450



The residual current module is used for AC and DC residual current detection in AC charging points. The higher-level safety equipment (e.g., residual current circuit breaker) is protected against potential DC residual currents. A 1 or 2-channel product version is available.

#### Feed-through terminal block - PT 16-TWIN N - 3208760



Feed-through terminal block, nom. voltage: 1000 V, nominal current: 76 A, connection method: Push-in connection, number of connections: 3, cross section: 0.5 mm<sup>2</sup> - 25 mm<sup>2</sup>, AWG: 20 - 4, width: 12.2 mm, height: 53.3 mm, color: gray, mounting type: NS 35/7,5, NS 35/15

## Set - EV-SET-T2AC-BAS-RCM1-20ASE12 - 1628080

### Articles in set

#### Feed-through terminal block - PT 16-TWIN N BU - 3208773



Feed-through terminal block, nom. voltage: 1000 V, nominal current: 76 A, connection method: Push-in connection, number of connections: 3, cross section: 0.5 mm<sup>2</sup> - 25 mm<sup>2</sup>, AWG: 20 - 4, width: 12.2 mm, height: 53.3 mm, color: blue, mounting type: NS 35/7,5, NS 35/15

---

#### Ground modular terminal block - PT 16-TWIN N-PE - 3208786



Ground modular terminal block, connection method: Push-in connection, number of connections: 3, cross section: 0.5 mm<sup>2</sup> - 25 mm<sup>2</sup>, AWG: 20 - 4, width: 12.2 mm, height: 53.3 mm, color: green-yellow, mounting type: NS 35/7,5, NS 35/15

---

#### Feed-through terminal block - PT 6 - 3211813



Feed-through terminal block, nom. voltage: 1000 V, nominal current: 41 A, connection method: Push-in connection, number of connections: 2, number of positions: 1, cross section: 0.5 mm<sup>2</sup> - 10 mm<sup>2</sup>, AWG: 20 - 8, width: 8.2 mm, height: 42.2 mm, color: gray, mounting type: NS 35/7,5, NS 35/15

---

#### Feed-through terminal block - PT 6 BU - 3211819



Feed-through terminal block, nom. voltage: 1000 V, nominal current: 41 A, connection method: Push-in connection, number of connections: 2, cross section: 0.5 mm<sup>2</sup> - 10 mm<sup>2</sup>, AWG: 20 - 8, width: 8.2 mm, height: 42.2 mm, color: blue, mounting type: NS 35/7,5, NS 35/15

---

#### Ground modular terminal block - PT 6-PE - 3211822



Ground modular terminal block, connection method: Push-in connection, number of connections: 2, cross section: 0.5 mm<sup>2</sup> - 10 mm<sup>2</sup>, AWG: 20 - 8, width: 8.2 mm, height: 42.2 mm, color: green-yellow, mounting type: NS 35/7,5, NS 35/15

## Set - EV-SET-T2AC-BAS-RCM1-20ASE12 - 1628080

### Articles in set

#### Feed-through terminal block - PT 2,5 - 3209510



Feed-through terminal block, nom. voltage: 800 V, nominal current: 24 A, connection method: Push-in connection, number of connections: 2, number of positions: 1, cross section: 0.14 mm<sup>2</sup> - 4 mm<sup>2</sup>, AWG: 26 - 12, width: 5.2 mm, height: 35.3 mm, color: gray, mounting type: NS 35/7,5, NS 35/15

#### Feed-through terminal block - PT 2,5-TWIN - 3209549



Feed-through terminal block, nom. voltage: 800 V, nominal current: 24 A, connection method: Push-in connection, number of connections: 3, cross section: 0.14 mm<sup>2</sup> - 4 mm<sup>2</sup>, AWG: 26 - 12, width: 5.2 mm, height: 35.2 mm, color: gray, mounting type: NS 35/7,5, NS 35/15

#### Feed-through terminal block - PT 2,5-TWIN BU - 3209552



Feed-through terminal block, nom. voltage: 800 V, nominal current: 24 A, connection method: Push-in connection, number of connections: 3, cross section: 0.14 mm<sup>2</sup> - 4 mm<sup>2</sup>, AWG: 26 - 12, width: 5.2 mm, height: 35.2 mm, color: blue, mounting type: NS 35/7,5, NS 35/15

#### Fuse modular terminal block - ZFK 6-DREHSI (5X20) - 3025040



Spring-cage terminal block-fuse terminal block for cartridge fuse inserts with screw cap, cross section: 0.5 - 6 mm<sup>2</sup>, width: 12 mm, color: black

#### Plug-in bridge - FBS 2-12 - 3005950



Plug-in bridge, pitch: 12 mm, number of positions: 2, color: red

## Set - EV-SET-T2AC-BAS-RCM1-20ASE12 - 1628080

### Articles in set

Plug-in bridge - FBS 3-5 - 3030174



Plug-in bridge, pitch: 5.2 mm, length: 22.7 mm, width: 14.2 mm, number of positions: 3, color: red

---

End cover - D-ST 2,5 - 3030417



End cover, length: 48.6 mm, width: 2.2 mm, height: 29.1 mm, color: gray

---

End cover - D-ST 2,5-TWIN - 3030488



End cover, length: 60.5 mm, width: 2.2 mm, height: 29 mm, color: gray

---

End cover - D-PT 6 - 3212044



End cover, length: 57.7 mm, width: 2.2 mm, height: 36 mm, color: gray

---

End cover - D-PT 16-TWIN N - 3208799



End cover, length: 100.2 mm, width: 2.2 mm, height: 46 mm, color: gray

---

## Set - EV-SET-T2AC-BAS-RCM1-20ASE12 - 1628080

### Articles in set

End clamp - CLIPFIX 35-5 - 3022276



Quick mounting end clamp for NS 35/7,5 DIN rail or NS 35/15 DIN rail, with marking option, with parking option for FBS...5, FBS...6, KSS 5, KSS 6, width: 5.15 mm, color: gray

---

### Classifications

#### eCl@ss

eCl@ss 10.0.1	27144792
eCl@ss 9.0	27144792

#### ETIM

ETIM 6.0	EC002884
ETIM 7.0	EC002884