



**DOL starter, 8-32A, protection electronic, advanced, SmartWire-DT**

**Part no.** MSC-DEA-32-M32-SP(24VDC)  
**Article no.** 167825  
**Catalog No.** XTFCE032BCCATD

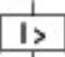
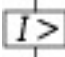
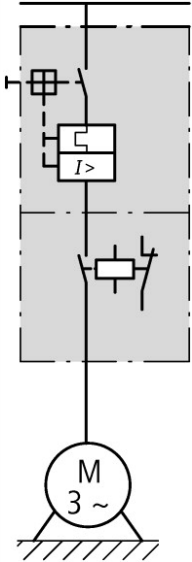

**Delivery program**

Basic function			Type E DOL starters (complete devices)
Basic device			MSC
Connection to SmartWire-DT			with PKE-SWD-32 for connecting the motor-starter combination
Components for			North America
<b>Maximum motor rating</b>			
AC HP = PS			
200 V 208 V		HP	5
230 V 240 V		HP	7.5
460 V 480 V		HP	15
<b>Short Circuit Current Rating</b>			
240 V		kA	18
480 Y 277 V		kA	18
<b>Setting range</b>			
Setting range of overload releases	$I_r$	A	8 - 32
			
Short-circuit releases			
			
Non-delayed	$I_{rm}$	A	496
			
Contact sequence			
Actuating voltage			24 V DC

			DC Voltage
<b>Motor-protective circuit-breakers</b> PKE32/XTU-32			
Contactor DILM32-10(...)			
<b>DOL starter wiring set</b>			
Mechanical connection element and electrical electric contact module PKZM0-XDM32			
Extension terminal BK25/3-PKZ0-E			
<b>Notes</b>			
The DOL starter type E (complete devices) consists of a PKE motor-protective circuit-breaker with AK-PKZ0, a DILM contactor and an extension terminal BK25/3-PKZ0-E.			
Motor-protective circuit-breaker and contactor mounted on top hat rail adapter plate.			
The connection of the main circuit between PKE and contactor is established with electrical contact modules.			
The MSC-DEA... DOL starters are prepared for communication via SmartWire-DT. In order to be used this way, they first need to be expanded with the PKE-SWD-32 communications module.			

## Technical data

### General

Standards			IEC/EN 60947-4-1, VDE 0660
-----------	--	--	----------------------------

### Main conducting paths

Rated impulse withstand voltage	$U_{imp}$	V AC	6000
Overvoltage category/pollution degree			III/3
Rated operational voltage	$U_e$	V	208 - 600
Rated operational current			
Open, 3-pole: 50 – 60 Hz			
380 V 400 V	$I_e$	A	32

### Additional technical data

Motor protective circuit breaker PKZM0, PKE			PKE motor-protective circuit-breaker, see motor-protective circuit-breaker product group DILM contactors, see contactors product group
---	--	--	---

### Power consumption

DC operated	Sealing	W	0.5
-------------	---------	---	-----

## Design verification as per IEC/EN 61439

Technical data for design verification			
Rated operational current for specified heat dissipation	$I_n$	A	32
Heat dissipation per pole, current-dependent	$P_{vid}$	W	9.7
Equipment heat dissipation, current-dependent	$P_{vid}$	W	29.1
Static heat dissipation, non-current-dependent	$P_{vs}$	W	0.86
Heat dissipation capacity	$P_{diss}$	W	0
Operating ambient temperature min.		°C	-25
Operating ambient temperature max.		°C	55
IEC/EN 61439 design verification			
10.2 Strength of materials and parts			
10.2.2 Corrosion resistance			Meets the product standard's requirements.
10.2.3.1 Verification of thermal stability of enclosures			Meets the product standard's requirements.
10.2.3.2 Verification of resistance of insulating materials to normal heat			Meets the product standard's requirements.
10.2.3.3 Verification of resistance of insulating materials to abnormal heat and fire due to internal electric effects			Meets the product standard's requirements.
10.2.4 Resistance to ultra-violet (UV) radiation			Meets the product standard's requirements.
10.2.5 Lifting			Does not apply, since the entire switchgear needs to be evaluated.
10.2.6 Mechanical impact			Does not apply, since the entire switchgear needs to be evaluated.
10.2.7 Inscriptions			Meets the product standard's requirements.
10.3 Degree of protection of ASSEMBLIES			Does not apply, since the entire switchgear needs to be evaluated.
10.4 Clearances and creepage distances			Meets the product standard's requirements.
10.5 Protection against electric shock			Does not apply, since the entire switchgear needs to be evaluated.
10.6 Incorporation of switching devices and components			Does not apply, since the entire switchgear needs to be evaluated.
10.7 Internal electrical circuits and connections			Is the panel builder's responsibility.
10.8 Connections for external conductors			Is the panel builder's responsibility.
10.9 Insulation properties			
10.9.2 Power-frequency electric strength			Is the panel builder's responsibility.

10.9.3 Impulse withstand voltage		Is the panel builder's responsibility.
10.9.4 Testing of enclosures made of insulating material		Is the panel builder's responsibility.
10.10 Temperature rise		The panel builder is responsible for the temperature rise calculation. Eaton will provide heat dissipation data for the devices.
10.11 Short-circuit rating		Is the panel builder's responsibility. The specifications for the switchgear must be observed.
10.12 Electromagnetic compatibility		Is the panel builder's responsibility. The specifications for the switchgear must be observed.
10.13 Mechanical function		The device meets the requirements, provided the information in the instruction leaflet (IL) is observed.

## Technical data ETIM 6.0

Low-voltage industrial components (EG000017) / Motor starter/Motor starter combination (EC001037)		
Electric engineering, automation, process control engineering / Low-voltage switch technology / Load breakout, motor breakout / Motor starter combination (ecl@ss8.1-27-37-09-05 [AJZ718010])		
Kind of motor starter		Direct starter
With short-circuit release		Yes
Rated control supply voltage $U_s$ at AC 50HZ	V	0 - 0
Rated control supply voltage $U_s$ at AC 60HZ	V	0 - 0
Rated control supply voltage $U_s$ at DC	V	24 - 24
Voltage type for actuating		DC
Rated operation power at AC-3, 230 V, 3-phase	kW	7.5
Rated operation power at AC-3, 400 V	kW	15
Rated power, 460 V, 60 Hz, 3-phase	kW	11
Rated power, 575 V, 60 Hz, 3-phase	kW	0
Rated operation current $I_e$	A	29.3
Rated operation current at AC-3, 400 V	A	32
Overload release current setting	A	8 - 32
Rated conditional short-circuit current, type 1, 480 Y/277 V	A	0
Rated conditional short-circuit current, type 1, 600 Y/347 V	A	0
Rated conditional short-circuit current, type 2, 230 V	A	0
Rated conditional short-circuit current, type 2, 400 V	A	0
Number of auxiliary contacts as normally open contact		0
Number of auxiliary contacts as normally closed contact		1
Ambient temperature, , upper operating limit	°C	60
Temperature compensated overload protection		Yes
Release class		Adjustable
Type of electrical connection of main circuit		Screw connection
Type of electrical connection for auxiliary- and control current circuit		Screw connection
Rail mounting possible		Yes
Degree of protection (IP)		IP20
Supporting protocol for TCP/IP		No
Supporting protocol for PROFIBUS		No
Supporting protocol for CAN		No
Supporting protocol for INTERBUS		No
Supporting protocol for ASI		No
Supporting protocol for MODBUS		No
Supporting protocol for Data-Highway		No
Supporting protocol for DeviceNet		No
Supporting protocol for SUCONET		No
Supporting protocol for LON		No
Supporting protocol for PROFINET IO		No
Supporting protocol for PROFINET CBA		No
Supporting protocol for SERCOS		No
Supporting protocol for Foundation Fieldbus		No
Supporting protocol for EtherNet/IP		No
Supporting protocol for AS-Interface Safety at Work		No

Supporting protocol for DeviceNet Safety		No
Supporting protocol for INTERBUS-Safety		No
Supporting protocol for PROFIsafe		No
Supporting protocol for SafetyBUS p		No
Supporting protocol for other bus systems		Yes

## Approvals

Product Standards		UL60947-4-1A; CSA-C22.2 No. 14-10; IEC60947-4-1; CE marking
UL File No.		E123500
UL Category Control No.		NKJH
CSA File No.		165628
CSA Class No.		3211-08
North America Certification		UL listed, CSA certified
Specially designed for North America		Yes

## Dimensions

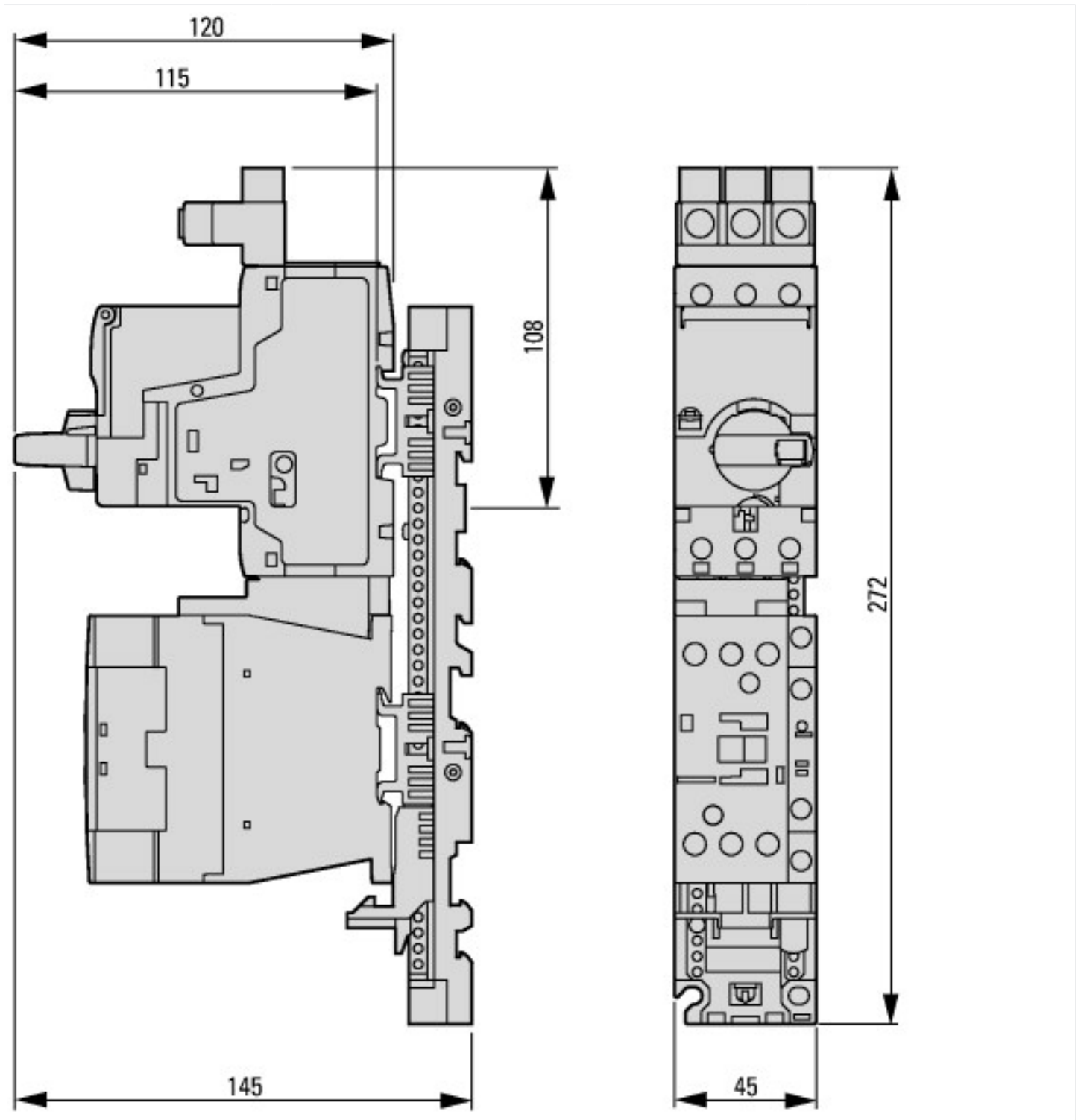

## Additional product information (links)

**IL03402052Z Motorstarter combination: type E starter/type F starter with PKE**

IL03402052Z Motorstarter combination: type E starter/type F starter with PKE [ftp://ftp.moeller.net/DOCUMENTATION/AWA\\_INSTRUCTIONS/IL03402052Z2014\\_02.pdf](ftp://ftp.moeller.net/DOCUMENTATION/AWA_INSTRUCTIONS/IL03402052Z2014_02.pdf)