







DOL starter, 3p, 7.5kW/400V/AC3, 100kA, protection electronic

Part no. MSC-DE-32-M17(24VDC)
Article no. 121748
Catalog No. XTSE032B018CTDNL

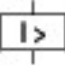
Delivery program

Basic function				DOL starters (complete devices)
Basic device				MSC
				
Notes				Also suitable for motors with efficiency class IE3. IE3-ready devices are identified by the logo on their packaging.
Motor ratings				
Motor rating				
AC-3				
380 V 400 V 415 V	P	kW		7.5
500 V	P	kW		7.5
Rated operational current				
AC-3				
400 V	I_e	A		15.2
500 V	I_e	A		12.1
Rated short-circuit current 380 - 400 V	I_q	kA		100
Rated conditional short-circuit current 500 V	I_q	kA		50
Setting range				
Setting range of overload releases	I_r	A		8 - 32
				
Short-circuit releases				
				
Non-delayed	I_{rm}	A		496
				
Coordination				Type of coordination "1" Type of coordination "2"

Contact sequence

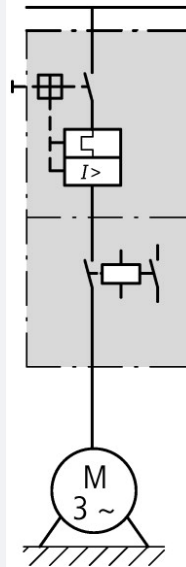

Actuating voltage

24 V DC

DC voltage

Motor-protective circuit-breakers PKE32/XTU-32

Contactor DILM17-10(...)

DOL starter wiring set

Mechanical connection element and electrical electric contact module PKZM0-XDM32

Notes

The DOL starter (complete devices) consists of a PKE motor protective circuit breaker and a DILM contactor.

With the adapter-less top-hat rail mounting of starters up to 15 A, only the motor-protective circuit-breaker on the top-hat rail requires an adapter.

The contactors are provided with mechanical support via a mechanical connection element.

Control wire guide with max. 6 conductors up to 2.5°mm external diameter or 4 conductors up to 3.5°mm external diameter.

From 16 A, the motor-protective circuit-breaker and contactor are mounted on the top-hat rail adapter plate.

The connection of the main circuit between PKE and contactor is established with electrical contact modules.

When using DILA-XHIT... auxiliary contacts with MSC-DE-... DOL starters, the plug-in electrical connectors can be removed without removing the front-mounted auxiliary contact.

Cannot be combined with NHI-E...PKZ0-C.

MSC-DEA... DOL starters are prepared for communications via SmartWire-DT. In order to be used this way, they first need to be expanded with the PKE-SWD-32 communications module.

Motor output/rated motor current

Motor output	AC-3	Rated motor current						
		220 V	380 V	415 V	440 V	500 V	500 V	660 V
		230 V	400 V				with	690 V
		240 V					CL-PKZ0	
		$I_q = 100 \text{ kA}$	$I_q = 100 \text{ kA}$	$I_q = 65 \text{ kA}$	$I_q = 65 \text{ kA}$	$I_q = 50 \text{ kA}$	$I_q = 100 \text{ kA}$	$I_q = 3 \text{ kA}$
P		I	I	I	I	I	I	I
kW		A	A	A	A	A	A	A
2.2		8.7	-	-	-	-	-	-
3		11.5	-	-	-	-	-	-
4		14.8	8.5	8.5	-	-	-	-
5.5		-	11.3	11.3	10.2	9	9	-
7.5		-	15.2	15.2	13.8	12.1	12.1	8.8

Technical data

General

Standards IEC/EN 60947-4-1, VDE 0660

Main conducting paths

Rated impulse withstand voltage U_{imp} V AC 6000

Overvoltage category/pollution degree III/3

Rated operational voltage U_e V 230 - 415

Rated operational current

Open, 3-pole: 50 – 60 Hz

380 V 400 V I_e A 17

Additional technical data

Motor protective circuit breaker PKZM0, PKE PKZM0 motor-protective circuit-breakers, see motor-protective circuit-breakers/
PKZM0 product group
DILM contactors, see contactors product group

Power consumption

DC operated	Sealing	W	0.5
-------------	---------	---	-----

Design verification as per IEC/EN 61439

Technical data for design verification			
Rated operational current for specified heat dissipation	I_n	A	17
Heat dissipation per pole, current-dependent	P_{vid}	W	2.7
Equipment heat dissipation, current-dependent	P_{vid}	W	8.2
Static heat dissipation, non-current-dependent	P_{vs}	W	0.86
Heat dissipation capacity	P_{diss}	W	0
Operating ambient temperature min.		°C	-25
Operating ambient temperature max.		°C	55
IEC/EN 61439 design verification			
10.2 Strength of materials and parts			
10.2.2 Corrosion resistance			
			Meets the product standard's requirements.
10.2.3.1 Verification of thermal stability of enclosures			
			Meets the product standard's requirements.
10.2.3.2 Verification of resistance of insulating materials to normal heat			
			Meets the product standard's requirements.
10.2.3.3 Verification of resistance of insulating materials to abnormal heat and fire due to internal electric effects			
			Meets the product standard's requirements.
10.2.4 Resistance to ultra-violet (UV) radiation			
			Meets the product standard's requirements.
10.2.5 Lifting			
			Does not apply, since the entire switchgear needs to be evaluated.
10.2.6 Mechanical impact			
			Does not apply, since the entire switchgear needs to be evaluated.
10.2.7 Inscriptions			
			Meets the product standard's requirements.
10.3 Degree of protection of ASSEMBLIES			
			Does not apply, since the entire switchgear needs to be evaluated.
10.4 Clearances and creepage distances			
			Meets the product standard's requirements.
10.5 Protection against electric shock			
			Does not apply, since the entire switchgear needs to be evaluated.
10.6 Incorporation of switching devices and components			
			Does not apply, since the entire switchgear needs to be evaluated.
10.7 Internal electrical circuits and connections			
			Is the panel builder's responsibility.
10.8 Connections for external conductors			
			Is the panel builder's responsibility.
10.9 Insulation properties			
10.9.2 Power-frequency electric strength			
			Is the panel builder's responsibility.
10.9.3 Impulse withstand voltage			
			Is the panel builder's responsibility.
10.9.4 Testing of enclosures made of insulating material			
			Is the panel builder's responsibility.
10.10 Temperature rise			
			The panel builder is responsible for the temperature rise calculation. Eaton will provide heat dissipation data for the devices.
10.11 Short-circuit rating			
			Is the panel builder's responsibility. The specifications for the switchgear must be observed.
10.12 Electromagnetic compatibility			
			Is the panel builder's responsibility. The specifications for the switchgear must be observed.
10.13 Mechanical function			
			The device meets the requirements, provided the information in the instruction leaflet (IL) is observed.

Technical data ETIM 6.0

Low-voltage industrial components (EG000017) / Motor starter/Motor starter combination (EC001037)			
Electric engineering, automation, process control engineering / Low-voltage switch technology / Load breakout, motor breakout / Motor starter combination (ecl@ss8.1-27-37-09-05 [AJZ718010])			
Kind of motor starter			Direct starter
With short-circuit release			Yes
Rated control supply voltage U_s at AC 50HZ		V	0 - 0
Rated control supply voltage U_s at AC 60HZ		V	0 - 0
Rated control supply voltage U_s at DC		V	24 - 24
Voltage type for actuating			DC
Rated operation power at AC-3, 230 V, 3-phase		kW	4
Rated operation power at AC-3, 400 V		kW	7.5
Rated power, 460 V, 60 Hz, 3-phase		kW	0
Rated power, 575 V, 60 Hz, 3-phase		kW	0
Rated operation current I_e		A	16.7

Rated operation current at AC-3, 400 V	A	17
Overload release current setting	A	8 - 32
Rated conditional short-circuit current, type 1, 480 Y/277 V	A	0
Rated conditional short-circuit current, type 1, 600 Y/347 V	A	0
Rated conditional short-circuit current, type 2, 230 V	A	100000
Rated conditional short-circuit current, type 2, 400 V	A	100000
Number of auxiliary contacts as normally open contact		1
Number of auxiliary contacts as normally closed contact		0
Ambient temperature, , upper operating limit	°C	60
Temperature compensated overload protection		Yes
Release class		Adjustable
Type of electrical connection of main circuit		Screw connection
Type of electrical connection for auxiliary- and control current circuit		Screw connection
Rail mounting possible		Yes
Degree of protection (IP)		IP20
Supporting protocol for TCP/IP		No
Supporting protocol for PROFIBUS		No
Supporting protocol for CAN		No
Supporting protocol for INTERBUS		No
Supporting protocol for ASI		No
Supporting protocol for MODBUS		No
Supporting protocol for Data-Highway		No
Supporting protocol for DeviceNet		No
Supporting protocol for SUCONET		No
Supporting protocol for LON		No
Supporting protocol for PROFINET IO		No
Supporting protocol for PROFINET CBA		No
Supporting protocol for SERCOS		No
Supporting protocol for Foundation Fieldbus		No
Supporting protocol for EtherNet/IP		No
Supporting protocol for AS-Interface Safety at Work		No
Supporting protocol for DeviceNet Safety		No
Supporting protocol for INTERBUS-Safety		No
Supporting protocol for PROFIsafe		No
Supporting protocol for SafetyBUS p		No
Supporting protocol for other bus systems		No

Dimensions

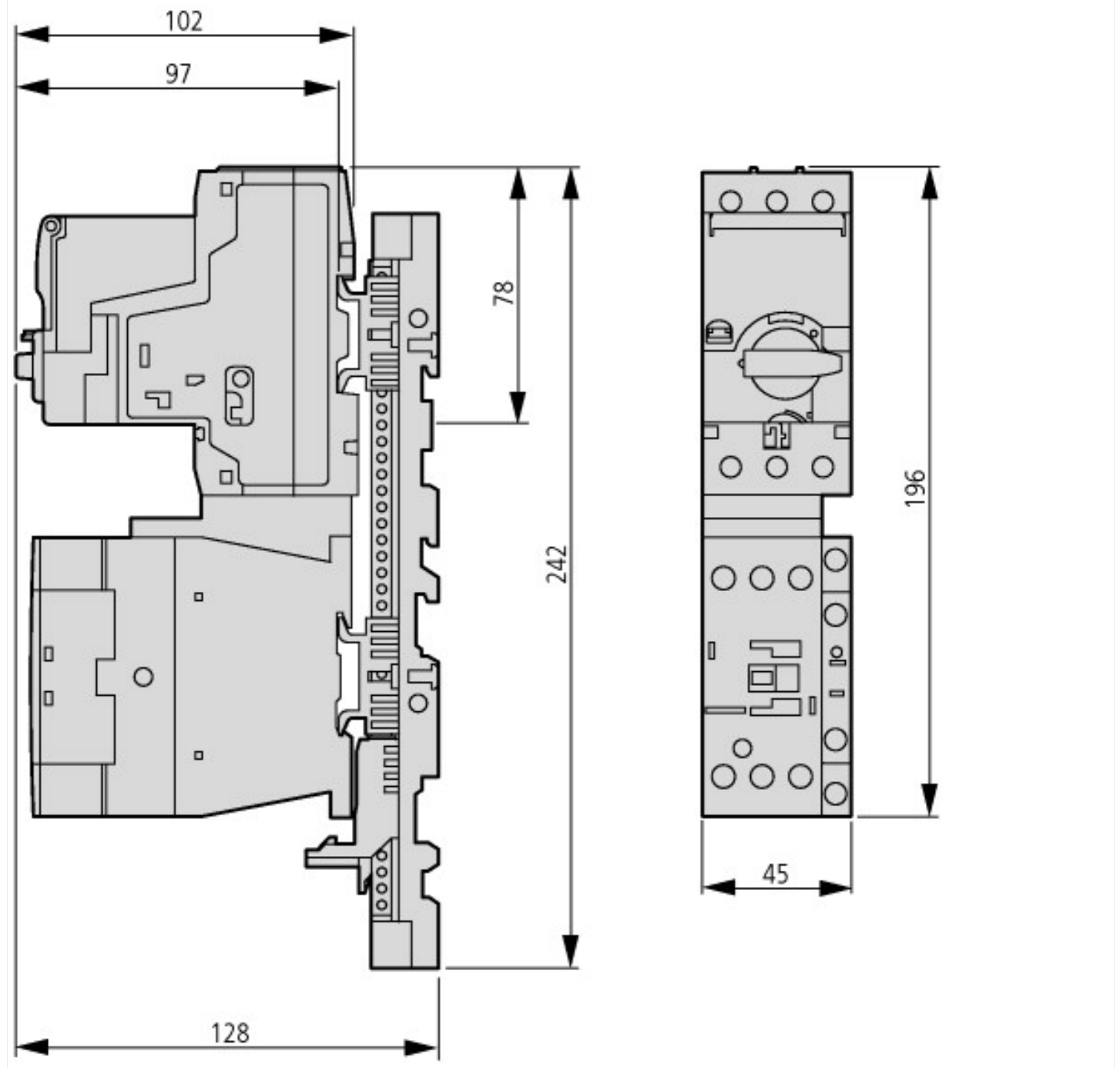

Additional product information (links)

IL03402010Z (AWA1210-2265) DOL starter up to 32 A

IL03402010Z (AWA1210-2265) DOL starter up to 32 A ftp://ftp.moeller.net/DOCUMENTATION/AWA_INSTRUCTIONS/IL03402010Z2012_09.pdf

Moeller_Online Selections Aids <http://www.moeller.net/en/support/slider/index.jsp>