



**Contactors, 3p+1N/O, 7.5kW/400V/AC3**

**Part no. DILM15-10(208V60HZ)**  
**Article no. 290052**  
**Catalog No. XTCE015B10E**

## Design verification as per IEC/EN 61439

| Technical data for design verification   |            |   |  |
|--|------------|---|--|
| Rated operational current for specified heat dissipation   | $I_n$      | A | 15.5   |
| Heat dissipation per pole, current-dependent   | $P_{vid}$  | W | 0.5  |
| Equipment heat dissipation, current-dependent  | $P_{vid}$  | W | 0  |
| Static heat dissipation, non-current-dependent   | $P_{vs}$   | W | 1.4  |
| Heat dissipation capacity  | $P_{diss}$ | W | 0  |
| IEC/EN 61439 design verification   |            |   |  |
| 10.2 Strength of materials and parts   |            |   |  |
| 10.2.2 Corrosion resistance  |            |   | Meets the product standard's requirements.   |
| 10.2.3.1 Verification of thermal stability of enclosures   |            |   | Meets the product standard's requirements.   |
| 10.2.3.2 Verification of resistance of insulating materials to normal heat   |            |   | Meets the product standard's requirements.   |
| 10.2.3.3 Verification of resistance of insulating materials to abnormal heat and fire due to internal electric effects |            |   | Meets the product standard's requirements.   |
| 10.2.4 Resistance to ultra-violet (UV) radiation   |            |   | Meets the product standard's requirements.   |
| 10.2.5 Lifting   |            |   | Does not apply, since the entire switchgear needs to be evaluated.   |
| 10.2.6 Mechanical impact   |            |   | Does not apply, since the entire switchgear needs to be evaluated.   |
| 10.2.7 Inscriptions  |            |   | Meets the product standard's requirements.   |
| 10.3 Degree of protection of ASSEMBLIES  |            |   | Does not apply, since the entire switchgear needs to be evaluated.   |
| 10.4 Clearances and creepage distances   |            |   | Meets the product standard's requirements.   |
| 10.5 Protection against electric shock   |            |   | Does not apply, since the entire switchgear needs to be evaluated.   |
| 10.6 Incorporation of switching devices and components   |            |   | Does not apply, since the entire switchgear needs to be evaluated.   |
| 10.7 Internal electrical circuits and connections  |            |   | Is the panel builder's responsibility.   |
| 10.8 Connections for external conductors   |            |   | Is the panel builder's responsibility.   |
| 10.9 Insulation properties   |            |   |  |
| 10.9.2 Power-frequency electric strength   |            |   | Is the panel builder's responsibility.   |
| 10.9.3 Impulse withstand voltage   |            |   | Is the panel builder's responsibility.   |
| 10.9.4 Testing of enclosures made of insulating material   |            |   | Is the panel builder's responsibility.   |
| 10.10 Temperature rise   |            |   | The panel builder is responsible for the temperature rise calculation. Eaton will provide heat dissipation data for the devices. |
| 10.11 Short-circuit rating   |            |   | Is the panel builder's responsibility. The specifications for the switchgear must be observed.                                   |
| 10.12 Electromagnetic compatibility  |            |   | Is the panel builder's responsibility. The specifications for the switchgear must be observed.                                   |
| 10.13 Mechanical function  |            |   | The device meets the requirements, provided the information in the instruction leaflet (IL) is observed.                         |

## Technical data ETIM 6.0

| Low-voltage industrial components (EG000017) / Power contactor, AC switching (EC000066)  |    |  |           |
|--|----|--|-----------|
| Electric engineering, automation, process control engineering / Low-voltage switch technology / Contactor (LV) / Power contactor, AC switching (ecl@ss8.1-27-37-10-03 [AAB718012]) |    |  |           |
| Rated control supply voltage $U_s$ at AC 50HZ  | V  |  | 0 - 0     |
| Rated control supply voltage $U_s$ at AC 60HZ  | V  |  | 208 - 208 |
| Rated control supply voltage $U_s$ at DC   | V  |  | 0 - 0     |
| Voltage type for actuating   |    |  | AC        |
| Rated operation current $I_e$ at AC-1, 400 V   | A  |  | 18        |
| Rated operation current $I_e$ at AC-3, 400 V   | A  |  | 15.5      |
| Rated operation power at AC-3, 400 V   | kW |  | 7.5       |
| Rated operation current $I_e$ at AC-4, 400 V   | A  |  | 7         |
| Rated operation power $I_e$ at AC-4, 400 V   | kW |  | 3         |
| Modular version  |    |  | No        |

|   |  |                  |
|---|--|------------------|
| Number of auxiliary contacts as normally open contact   |  | 1                |
| Number of auxiliary contacts as normally closed contact |  | 0                |
| Type of electrical connection of main circuit           |  | Screw connection |
| Number of normally closed contacts as main contact      |  | 0                |
| Number of main contacts as normally open contact        |  | 3                |

## Dimensions

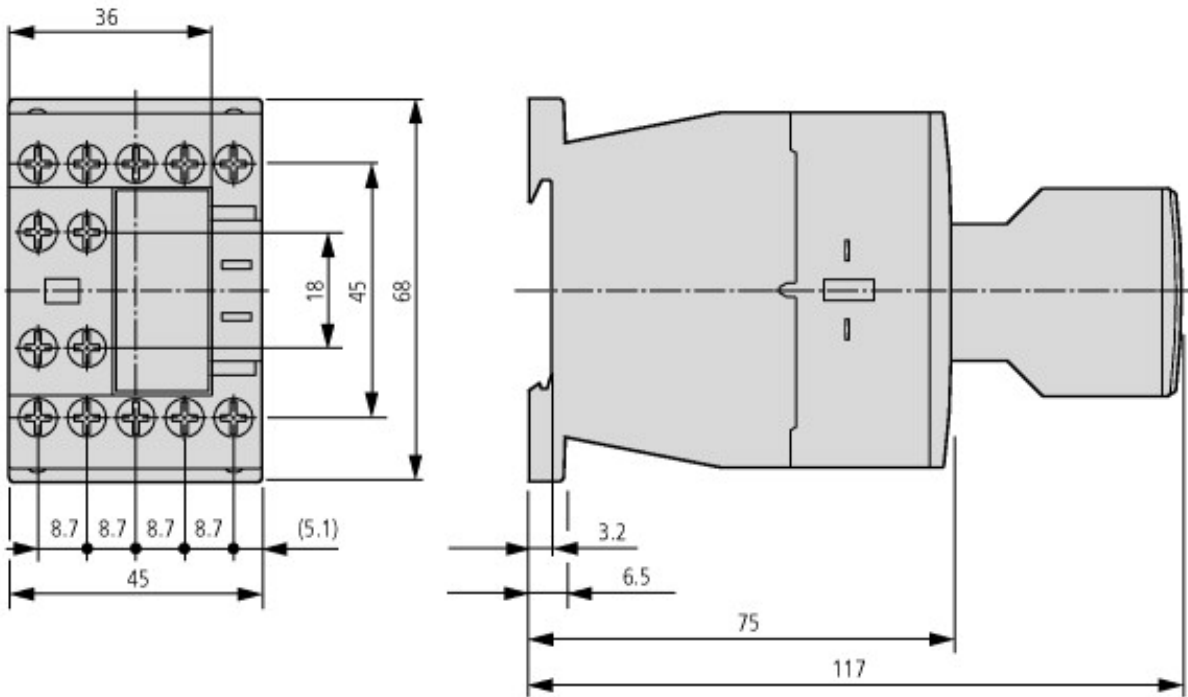

Contactor with auxiliary contact module

